

# SIOBLAST TC

## SETUP GUIDE

### FRONT SUSPENSION

Shock position

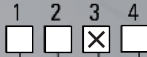

Upper arm position

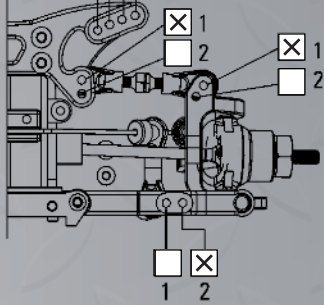

Caster angle  
Standard: 10°  
Option: 4°

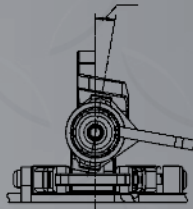

Front shock  
Oil: LRP 50 WT  
Pistons: Std  
Spacer: 0mm  
Springs: std

Sway bar  
Diameter: \_\_\_\_\_ mm

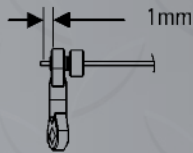

Toe angle

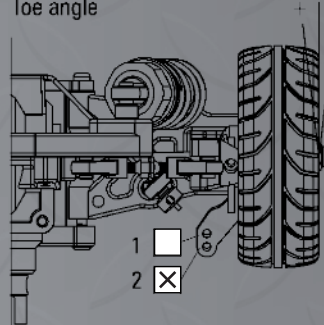

Front toe angle 0  
Notes \_\_\_\_\_  
Rear toe angle 2.5  
Notes \_\_\_\_\_

Camber angle

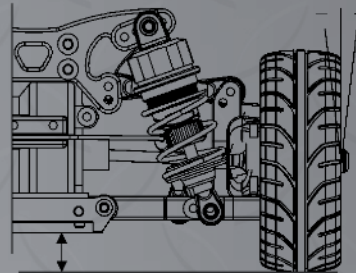

Camber front -1  
Notes \_\_\_\_\_  
Camber rear -1.5  
Notes \_\_\_\_\_

Rideheight front 5mm  
Rideheight rear 5mm

### REAR SUSPENSION

Shock position

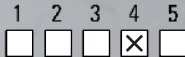

Upper arm position

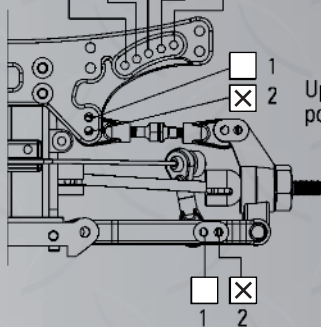

Wheelbase adjustment

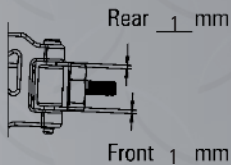

Rear shock  
Oil: LRP 50 WT  
Pistons: std  
Spacer: 0mm  
Springs: std

Sway bar  
Diameter: \_\_\_\_\_ mm

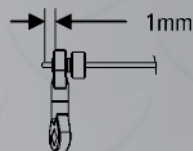

Tire

|                                |                                |
|--------------------------------|--------------------------------|
| Front                          | Rear                           |
| Type: <u>HPI Classic Wheel</u> | Type: <u>HPI Classic Wheel</u> |
| Foam: _____                    | Foam: _____                    |

|                             |                               |
|-----------------------------|-------------------------------|
| Motor: <u>LRP X12 17.5T</u> | Battery: <u>LRP 4600 Lipo</u> |
| Spur Gear: <u>58</u>        | ESC: <u>SXX Stock Spec V2</u> |
| Pinion Gear: <u>28</u>      | Servo: <u>Sanwa SDX 801</u>   |

Track conditions

Size:  Open  Med  Tight  
Traction:  High  Med  Low  
Surface:  Carpet  Asphalt

Diff Oil

Front: LRP 30000wt  
Rear: LRP 15000wt

Comment

Chevrolet Camaro Z28R 1969 Karosserie 200mm

Name: Florian Schimm

Date: 18.11.2012

Track: MAC Solms