



USER MANUAL



LRP electronic GmbH
Wilhelm-Enssle-Str. 132-134
73630 Remshalden
Germany

info@LRP.cc
www.LRP.cc

1. INSTALLATION

- Connect the speed-control to the receiver (position: Channel 2)

BRUSHLESS MOTOR:

The LRP SPX BULLET REVERSE comes pre-wired using common JST motor connectors. It's simply „plug & play“ when you intend using a designated LRP Brushless motor, see picture below! You can of course also use the supplied optional 3.3mm² power wires for a „hardwired“ setup without connectors.

- Blue power-wire ▶ Speedo MOT.A to motor „A“
- Yellow power-wire ▶ Speedo MOT.B to motor „B“
- Orange power-wire ▶ Speedo MOT.C to motor „C“

- Connect the hall sensor cable to the speed-control and the motor.

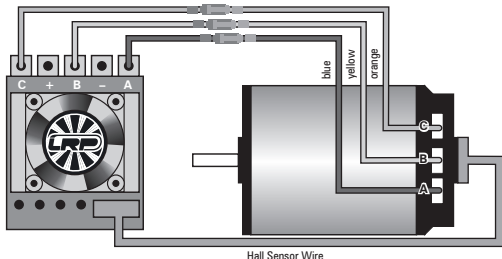

BRUSHED MOTOR:

- MOT.A (blue) and MOT.B (yellow) will be the combined „minus“ on the brushed motor.
- MOT.C (orange) wire will be „plus“ on the brushed motor.

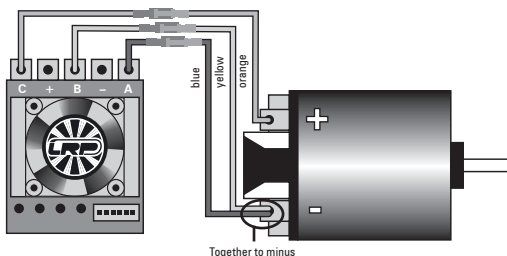

- Doublecheck all connections before connecting the speed-control to a battery.
- CAUTION:** If battery is connected with reversed polarity it will destroy your speed-control!
- Red power-wire ▶ Speedo BAT+ to battery „Plus“
- Black power-wire ▶ Speedo BAT- to battery „Minus“
- The speed-control is now ready to be set-up (see section 6).

2. CONNECTIONS

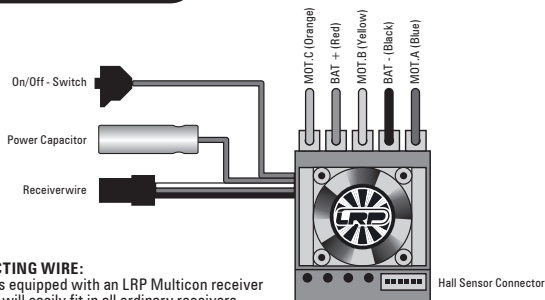

RECEIVER CONNECTING WIRE:
This speed-control is equipped with an LRP Multicon receiver wire. As supplied, it will easily fit in all ordinary receivers.

HALL SENSOR WIRE:

This bi-directional multipole wire (which comes with the motor and NOT the speed-control!) connects the speed-control and the motor. Do not alter or modify this cable! There are replaceable/optional hall sensor wires available: • #81910 (20cm) • #81920 (10cm)

POWER WIRES:

The LRP SPX BULLET REVERSE comes pre-wired using common Tamiya/JST battery connector and JST motor connectors. It's simply „plug & play“ when you intend using a designated LRP Brushless motor! There is a complete set of 3.3mm² power wires included, which allow you to use a „hardwired“ wire setup. The unique splitted solder-tabs allow easy and convenient replacement of the power wires. Nevertheless some soldering skills are required. Talk to your local hobbyshop if you are concerned about replacing the wires yourself. There is a replacement power wire set available: #81906

CAUTION: Be very careful with the correct wire sequence since an incorrect connection may damage the speed-control! Avoid creating solder bridges on the solder-tabs and isolate all connections carefully. Avoid soldering longer than 5sec per soldering joint.

Dear Customer,

thank you for your trust in this LRP product. By purchasing a LRP SPX BULLET REVERSE speed-control, you have chosen one of the most advanced speed-controls of today. This speed-control with all of its high-tech features and specially selected electronic components is offering great value for the money.

- 4 speed controls in 1 (Brushless, Brushed, Fwd/Brk/Rvs, Fwd/Brk)
- 4 fully adjustable modes
- Sensored Design
- Advanced Digital
- Small and Lightweight
- IceDrive Design
- AutoCell System
- Internal-Temp-Check system
- 4, 5, and 6 cell optimised
- Big Power Capacitor
- additional 3.3mm² Power-Wire-Set included

Please read the following instructions carefully before you start using your LRP SPX BULLET REVERSE speed control. This user guide contains important notes for the safety, the use and the maintenance of this product. Thus protecting yourself and avoid damages of the product.

Proceed according to the user guide in order to understand your LRP SPX BULLET REVERSE speed control better. Please take your time as you will have much more joy with your product if you know it exactly.

This user manual shall be kept in a safe place. If another customer is using this product, this manual has to be handed out together with it.

3. SPECIFICATIONS

Brushless + Brushed	yes	Typ. Voltage Drop (Brushed) ¹	@20A - 0.010V
Brushless + Brushed adaption	AUTOMATIC	Rated Current (Brushed) ⁴	400A
Forward/Brake	yes	B.E.C.	6.0V/3.0A
Forward/Brake/Reverse	yes	High Frequency	yes
Case Size	33.1x37.6x32.5mm	Sensored Brushless System	yes
Weight (excl. wires)	45g	Multi-Protection-System	yes
Voltage Input	4.8-8.4V	Connectors	Std. Tamiya Style
Rec. Motor Limit for Star winds (Brushless) ²	over 3 turns	Power Wires (additional)	3.3mm ²
Rec. Motor Limit (Brushed) ²	über 4 turns	4, 5, 6 cell optimised	yes
Typ. Voltage Drop (Brushless) ¹	@20A - 0.013V / phase	Internal-Temp-Check System	yes
Rated Current (Brushless) ⁴	400A / phase		
Compatible winding styles (Brushless)	Star		
4 adjustable modes (NiMH/LiPo, Forward/Brake - Forward/Brake/Reverse, Power Profiles, Auto-Brake)	yes		

⁴ Transistors rating at 25°C junction temperature measured at 7.2V

Specifications subject to change without notice.

4. INSTALLATION TIPS

- Mount the speedo using the supplied thick/black doubled-sided tape.
- Position the speed-control where it is protected in the event of a crash.
- Install the speed-control so that you have easy access to the connector and buttons.
- Make sure there is enough clearance (about 3cm) between the speed-control, power-wires, antenna and receiver. Avoid any direct contact between power components, the receiver or the antenna. This can cause interference. If interference occurs, position the components at a different place in the model.
- The aerial should be run vertically up and away from the receiver. Avoid contact with any parts made of carbon fibre or metal. If the aerial is too long, don't coil up the excess length. It is better to cut it down to a length of about 35 cm. See also the instructions supplied with your radio control system.
- Make sure there are enough cooling slits in the body. This will increase the performance and life of all the electronic components.

HEATSINK: To achieve best performance even under extreme conditions, the heatsink has been directly mounted to the speed-control. This ensures the best possible heat transfer away from the speed-control.

Caution: Never attempt to remove the heatsink, because the speed-control will get damaged if you do this. The heatsink is an integral part of the speed-control and therefore cannot be removed.

Because of the physical principles of brushless technology, the speed-controls do get a little hotter than brushed systems. Therefore it is required to let the speed-control cool down completely after every run.



LRP SPX BULLET REVERSE with heat sink.

5. SUPPRESSION

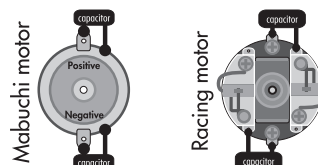

ONLY FOR BRUSHED MOTORS! Motors with no capacitors or not enough capacitors may interfere with the speed-control. To avoid this, solder the supplied capacitors to your motor (see picture).

6. RADIO / SPEED-CONTROL SET-UP

In setup mode the LRP SPX BULLET REVERSE stores every step when you press the SET button. All the settings will be stored in the speed-controls memory even if the speed-control will be disconnected from the battery.

TRANSMITTER SETTINGS

Setup the following basic functions on your transmitter (if available):

Throttle travel	High ATV, EPA	maximum
Brake travel	Low ATV, EPA, ATL	maximum
Throttle exponential	EXP, EXPO	start with 0
Neutral trim	SUB Trim	centre
Servo reverse	Throttle reverse	any setting, don't change after set-up procedure!

If your transmitter doesn't offer any of above functions, it's already in „basic setup“ mode.

- Ensure that the speed-control is not connected to the drive battery and is switched off.
- Remove motor pinion or ensure that the wheels of the model are free to rotate.
- Switch the transmitter on and set the transmitter throttle stick to neutral.

- Connect the speed-control to the battery, and switch the unit on.
- Hold the SET button pressed for at least 3sec using the supplied plastic screwdriver.
 - ▶ You entered setup mode and the SET LED flashes red (it will flash until the setup is completed).

- Leave transmitter in neutral position and press the SET button once.
 - ▶ Neutral setting is stored, MODE LED flashes green and the motor beeps.
- Hold full throttle on transmitter and press the SET button once.
 - ▶ Full-throttle setting is stored, MODE LED flashes red.
- Hold full reverse on transmitter and press the SET button once.
 - ▶ Reverse setting is stored, LED's glow red (MODE) and red (SET).

- This completes the setup procedure and your LRP SPX BULLET REVERSE is ready to use.
- If you make a mistake during the setup procedure, don't worry: Disconnect the battery for about 10sec and start again from the first step.
- At the end of each run switch of the car, and then switch off the transmitter.
- At the start of each run switch on the transmitter first, then switch on the car.
- For storage of the car, disconnect the drive battery at any time!

CHECKING THE FUNCTIONS:

Check the LED's when moving your throttle stick and you will see if everything is setup correctly.

FUNCTION	STATUS	MODE LED	SET LED
Neutral (automatic brake inactive)	--	off	red
Neutral (automatic brake active)	--	red	off
Forward	partial throttle	green	off
Forward	full throttle	green	red
Brake/Reverse	partial brake/reverse	red	off
Brake/Reverse	full brake/reverse	red	red

7. MODE PROGRAMMING

All modes are available for brushless and brushed motors (speedo adapts automatically). The LRP SPX BULLET REVERSE features 4 modes which enable you to adjust it to YOUR special requirements. The factory settings are shown in grey colour.

- How to get into „programming the modes“
 - ▶ Press MODE button for 3 or more seconds.
- How to check the stored values
 - ▶ Count the number of flashes of the red SET-LED (1x = value 1, 2x = value 2, etc.).
- How to change the value
 - ▶ Press SET button to increase value by one step.
- How to get to the next Mode
 - ▶ Press MODE button once.
- How to leave the programming mode
 - ▶ If you are in MODE.4, press the MODE button one more time
- Table of settings, values and modes: see below (grey-shaded values show „works default settings“)

MODE.1 - AutoCell SYSTEM

we recommend using value 2 for 4-6 cells NiMH racing purposes, which disengages the LiPo protection.

MODE LED	Value 1	Value 2
Green	LiPo Mode	NiMH Racing Mode

MODE.2 - FORWARD/BRAKE/REVERSE - FORWARD/BRAKE

the LRP SPX BULLET REVERSE contains 4 speed-controls in 1! Brushless or brushed it adapts automatically and here you can select between forward/brake/reverse and forward/brake „racing style“ operation.

MODE LED	Value 1	Value 2
Red	Forward Reverse	Forward Brake

MODE.3 - POWER PROFILES

allows you to adjust the LRP SPX BULLET REVERSE to your likes. Either you run on slippery or high-traction surfaces, we have incorporated a profile for you! Higher value means more overall power and more aggressive throttle response.

MODE LED	Value 1	Value 2	Value 3	Value 4
Green/Red (alternate)	Smooth	Linear	Progressive	Aggressive

MODE.4 - AUTO-/DRAGBRAKE

allows you to set a slight braking action which is applied in the neutral range. This enables you to simulate the feel of a brushed motor and also hold the throttle on longer when entering a turn. Your car also has more front traction with this setting.

For brushless motors you achieve the same natural slowdown as a brushed motor with no autobrake when you set value 1-2 (for motors with bonded magnets) or 0-1 (for motors with sintered magnets).

MODE LED	Value 0	Value 1	Value 2	Value 3	Value 4
Green/Red (same time)	No Automatic Brake	increasing from low (#1) to high (#4) autobrake settings			

8. SPECIAL FEATURES

Internal-Temp-Check System: the LRP SPX BULLET REVERSE allows you to read-out the maximum internal temperature that the speedo reached. To save it to the memory you have to briefly apply brakes after the run before you turn the switch off. You can conveniently read-out the temperature back in the pits since it remains stored until you turn it on the next time regularly (which will reset the memory). This new feature allows you to accurately check if all is running well or if you're close to shutdown already.

How to read-out the temperature:

- ▶ Switch at „OFF“ position.
- ▶ Keep MODE button pressed while you turn switch to „ON“ (then release button)
- ▶ SET LED will start to flash red (MODE LED is off), now count the number of flashes.

Basics:

- Thermal shutdown of the speedo would occur at 6 flashes.
- The higher the number of flashes, the cooler the speedo ran (e.g. the better it is!)
- Every flash equals to ~8°C temperature decrease

Example:

- ▶ you count 10 flashes after the run
- ▶ 10 - 6 = 4 (e.g. 4 flashes „away“ from shutdown)
- ▶ 4 x 8°C = 32°C (e.g. you are 32°C away from thermal shutdown and therefore safe!)

AutoCell System: Ready for the next battery technology – LiPo batteries! LRP's exclusive and smart AutoCell System ensures that LiPo batteries can be used safely without accidentally deep-discharging of the cells. The motor function will be shut-off and the SET LED will flash if the system recognises very low battery voltage.

TIP: We recommend using value 2 for 4-6 cells NiMH racing purposes, which disengages the LiPo protection.

Automatic Brushless / Brushed Adaption: The LRP exclusive Automatic Brushless/Brushed Adaption detects the connected motor type during turn-on/initialisation and adjusts the correct brushless or brushed operation automatically. No adjustments required by yourself, apart from the correct connection of each motor type (don't forget the hall-sensor-wire for brushless!).

CAUTION: Keep in mind, when swapping between brushless and brushed motors, that the chosen mode values will be identical!

Changing Mode settings without the transmitter: At race events you usually do not have access to your transmitter, but never mind since you can simply disconnect the receiver lead from the receiver and change the MODE settings as described in section 7 „Mode Programming“.

IceDrive Design: LRP's secret IceDrive Design results in lower speedo temperature under all racing conditions and for both brushless + brushed. Sorry, no further details to be disclosed. Simply a step ahead of the competition!

Works-Default-Settings: All LRP speed-controls come factory-adjusted (defaults are grey-shaded above). If you loose track of the modes, you can restore the works default settings. With the transmitter switched on, hold the SET button pressed while you switch on the speed-control. This simple action returns the unit to the LRP works default settings.

Power Capacitor: Never disconnect the power-capacitor! It is required for proper function, a special Super-Low ESR type has been chosen, which offers increased punch and additional protection, therefore only use genuine LRP power capacitors.

Sensored Brushless Technology: Advanced Digital allows the perfect knowledge of the brushless motor's magnet position. This results in perfect motor control at high and low RPM's, as well as perfect brake control.

Multi-Protection System: The perfect protection against short-circuits (motor), overload and overheating. If your speed-control faces overload, the motor function will be shut-off for protection and the SET LED will flash, although the steering function is maintained. Let the speed-control cool down for a few minutes. If you experience frequent shutdowns, check for the following:

- Correct gear ratio (refer to motor manual for gearing recommendations)
- ADPC setting too high (higher value will heat up motor and speed-control excessively)
- Motor is too strong or motor is damaged.

9. TROUBLESHOOTING GUIDE

EXPLANATION: If no remark, cause can be either with brushless or brushed motor. If „BM“ is indicated, cause only relating to brushed motor.

SYMPTOM	CAUSE	REMEDY	
Servo is working, no motor function.	Speed-control plugged in incorrectly	Plug speed-control in Ch 2	
	Overload protection activated	Allow speed-control to cool down	
	Wiring problem	Check wires and plugs	
	Motor defective	Replace motor	
	BM - Motor brushes stuck	Check that brushes are moving freely	
No servo and no motor function.	Speed-control defective	Send in product for repair	
	Speed-control plugged in incorrectly	Plug speed-control in with correct polarity	
	Crystal defective	Replace components one by one.	
	Receiver defective		
	Transmitter defective		
Speed-control defective	Send in product for repair		
Motor runs in reverse when accelerating forward on the transmitter.	BM - Motor connected incorrectly	Connect motor correctly	
	Insufficient performance. E.g. poor brake power, topspeed or acceleration..	Motor pinion too big or gear ratio too long.	Use smaller motor pinion/shorter gear ratio
		Transmitter settings changed after set-up	Repeat set-up procedure
		BM - Motor worn out	Maintain motor
		Motor defective	Replace motor
Speed-control overheats or switches off frequently.	Speed-control defective.	Send in product for repair	
	Motor stronger than motor limit or input voltage too high	Use only motors and batteries which are within the specifications of the speed-control	
	Motor pinion too big or gear ratio too long.	Use smaller motor pinion/shorter gear ratio	
	Drive train or bearing problems.	Check or replace components.	
	Model used too often without cool-down periods	Let speed-control cool down after every run	
Motor never stops, runs at constant slow speed	Transmitter settings changed after set-up	Repeat set-up procedure	
	Humidity/water in speed-control	Immediately unplug and dry speed-control	
	Speed-control defective	Send in product for repair	
	Radio interference	BM - Motor suppressors not sufficient	Solder capacitors to motor
Receiver or antenna too close to power wires, motor, battery or speed-control.		See „Installation Tips“ and „Installation“	
Receiver aerial too short or coiled up			
Receiver defective, too sensitive; Transmitter defective, transmitter output power too low, servo problem		Replace components one by one	
Poor battery connection		Check plugs and connecting wires	
Transmitter batteries empty		Replace / recharge transmitter batteries	
Transmitter antenna too short		Pull out antenna to full length	

**WARNHINWEISE**

Kein Spielzeug. Nicht für Kinder unter 14 Jahren geeignet.

Bewahren Sie das Produkt außerhalb der Reichweite von kleinen Kindern auf.

Beachten Sie unbedingt die folgenden Hinweise, da diese Ihr Produkt zerstören können und die Gewährleistung ausschließen. Nichtbeachtung dieser Hinweise können zu Sach- und Personenschäden und schweren Verletzungen führen!

- Lassen Sie das Produkt niemals unbeaufsichtigt, solange es eingeschaltet, in Betrieb oder mit einer Stromquelle verbunden ist. Im Falle eines Defekts könnte dies Feuer am Produkt oder seiner Umgebung verursachen.
- Wickeln Sie Ihr Produkt niemals mit Plastikfolie, Metallfolie oder Ähnlichem ein, sondern sorgen Sie im Gegenteil für Frischluft.
- Vermeiden Sie falschen Anschluss oder Verpolung des Produkts.
- Alle Kabel und Verbindungen müssen gut isoliert sein. Kurzschlüsse können unter Umständen das Produkt zerstören.
- Dieses Produkt oder andere elektronische Komponenten dürfen niemals mit Wasser, Öl, Treibstoffen oder anderen elektrisch leitenden Flüssigkeiten in Berührung kommen, da diese Mineralien enthalten können, die elektronische Schaltkreise korrodieren lassen. Bei Kontakt mit diesen Stoffen müssen Sie sofort den Betrieb einstellen und das Produkt sorgfältig trocknen.
- Die Originalstecker und Originalkabel dürfen niemals verändert oder abgeschnitten werden.
- Öffnen Sie niemals das Produkt und löten Sie keinesfalls auf der Platine oder anderen Komponenten
- Benutzen Sie Ihr Produkt nicht mit geöffnetem, beschädigtem oder fehlendem Gehäuse oder in Schrumpfschlauch. Dies mindert den Störschutz, kann Kurzschlüsse verursachen und das Produkt beschädigen.
- Entnehmen Sie immer den Akku aus Ihrem Produkt bzw. trennen Sie das Produkt von der Stromquelle, wenn das Produkt nicht verwendet wird.
- Schalten Sie immer zuerst Ihren Sender ein, bevor Sie den Empfänger oder Fahrtenregler einschalten. Der Empfänger könnte Störsignale auffangen, Vollgas geben, und Ihr Modell beschädigen. Beim Ausschalten beachten Sie die umgekehrte Reihenfolge. Erst Empfänger und Fahrtenregler ausschalten, dann Sender ausschalten.
- Geben Sie keinesfalls Vollgas, wenn der Motor noch nicht eingebaut ist. Durch die extrem hohen Drehzahlen ohne Last kann der Motor beschädigt werden.
- Löten Sie bei Verwendung dieses Reglers niemals eine Schottky-Diode an den Motor.
- Solange der Motor an den Regler angeschlossen ist, dürfen Sie niemals den Motor mit einem separaten Akku oder mit einem Motor-Einlaufgerät laufen lassen.
- Stellen Sie sicher, dass die Kühlbleche der Fets sich niemals berühren - Kurzschlussgefahr!
- Verändern Sie niemals die Polarität des Empfängersteckers.
- Schließen Sie sämtliche Teile der Ausrüstung sorgfältig an. Falls sich die Verbindungen durch Vibrationen lösen, können Sie die Kontrolle über das Modell verlieren.
- Vermeiden Sie es beim Wechseln der Powerkabel länger als 5 Sekunden je Lötstelle zu löten, um eine Beschädigung der Bauteile durch Überhitzung auszuschließen. Verwenden Sie zum Löten eine leistungsstarke Lötstation mit mind. 60W.
- **Der Hersteller kann nicht für Schäden verantwortlich gemacht werden, die infolge von Nichtbeachtung der Sicherheitshinweise und Warnungen verursacht werden.**

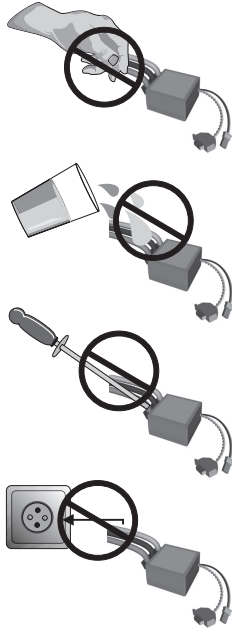
**WARNING NOTES**

No toy. Not suitable for children under 14 years.

Keep the product out of the reach of children.

Pay close attention to the following points, as they can destroy the product and void your warranty. Non-observance of these points can lead to property damage, personal and severe injuries!

- Never leave the product unsupervised while it is switched on, in use or connected with a power source. If a defect occurs, it could set fire to the product or the surroundings.
- Never wrap your product in plastic film, metal foil or similar. In fact, make sure it gets enough fresh air.
- Avoid incorrect connections or connections with reversed polarity of the product.
- All wires and connections have to be well insulated. Short-circuits can possibly destroy the product.
- Never allow this product or other electronic components to come in contact with water, oil or fuels or other electroconductive liquids, as these could contain minerals, which are harmful for electronic circuits. If this happens, stop the use of your product immediately and let it dry carefully.
- Never cut off or modify the original plugs and original wires.
- Never open the product and never solder on the PCB or other components.
- Never use this product when the case is open, damaged or missing or when the product is wrapped in a shrink-fit tube. This will reduce protection, may cause short circuits and damage the product.
- Always remove the battery from your product or disconnect the product from the power source, if the product is not in use.
- Always switch on your transmitter first before you switch on the receiver or the speed control. The receiver could receive interference signals, start full acceleration and damage your model. When you switch off, make sure you do so in the reverse sequence. First switch off the receiver and speed control, then switch off the transmitter.
- Never apply full throttle if the motor is not installed. Due to the extremely high RPMs without load, the motor can get damaged.
- Never solder a Schottky diode to the motor when you are using this speed-control.
- If the speed-control is connected to the motor, never run the motor directly with a separate battery or run-in device.
- Ensure, that the output stages (FETs) never touch a metal surface - Short-circuit hazard!
- Never change the polarity of the receiver connector.
- Always wire up all the parts of the equipment carefully. If any of the connections come loose as a result of vibration, you could lose control over your model.
- Avoid soldering longer than 5 seconds per soldering joint when replacing the power wires to prevent possible damage to the product due to overheating of the components. Use a high power soldering station with at least 60W for soldering.
- **The manufacturer can not be held responsible for damages, which are a result of non-observance of the warning notes and security advices.**

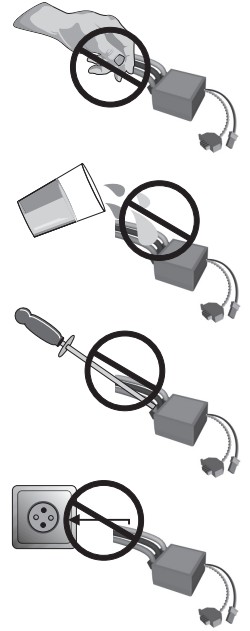

Das Symbol einer durchgestrichenen Abfalltonne auf Rädern bedeutet, dass das Produkt in der Europäischen Union einer getrennten Müllsammlung zugeführt werden muss. Diese Produkte dürfen nicht über den unsortierten Hausmüll entsorgt werden.



The crossed-out wheeled bin means that within the European Union the product must be taken to separate collection at the product end-of-life. Do not dispose of these products as unsorted municipal waste.

ALLGEMEINE GEWÄHRLEISTUNGS- UND REPARATURBESTIMMUNGEN

Produkte der LRP electronic GmbH (nachfolgend „LRP“ genannt) werden nach strengsten Qualitätskriterien gefertigt. Wir gewähren die gesetzliche Gewährleistung auf Produktions- und Materialfehler, die zum Zeitpunkt der Auslieferung des Produkts vorhanden waren. Für gebrauchstypische Verschleißerscheinungen wird nicht gehaftet. Diese Gewährleistung gilt nicht für Mängel, die auf eine unsachgemäße Benutzung, mangelnde Wartung, Fremdeingriff oder mechanische Beschädigung zurückzuführen sind.

Dies liegt unter Anderem vor bei:

- Stecker abgeschnitten bzw. kein verpolsichertes Stecksystem
- Empfängerkabel und/oder Schalter beschädigt
- Gehäuse mechanisch beschädigt
- Wasser/Wasserrückstände im Gehäuse
- Mechanische Beschädigung der Bauteile/Platine
- Auf der Platine gelötet (Ausnahme außen liegende Lötaschen)
- Akkuseitig verpolt

Bevor Sie dieses Produkt zur Reparatur einsenden, prüfen Sie bitte zunächst alle anderen Komponenten in ihrem Modell und schauen Sie ggf. in der Fehlerfibel des Produktes (sofern vorhanden) nach, um andere Störquellen und Bedienfehler auszuschließen. Sollte das Produkt bei der Überprüfung durch unsere Serviceabteilung keine Fehlfunktion aufweisen, müssen wir Ihnen hierfür die angefallenen Bearbeitungskosten laut Preisliste berechnen.

Mit der Einsendung des Produktes muss der Kunde mitteilen, ob das Produkt in jedem Fall repariert werden soll. Sollte kein Gewährleistungs- oder Garantieanspruch bestehen, erfolgt die Produktüberprüfung und ggf. Reparatur in jedem Falle kostenpflichtig gemäß unserer Preisliste. Ein Gewährleistungs- oder Garantieanspruch kann nur anerkannt werden, sofern eine Kopie des Kaufbelegs beigelegt ist. Auf Ihre ausdrückliche Anforderung erstellen wir einen kostenpflichtigen Kostenvorschlag. Wenn Sie nach Zusendung des Kostenvorschlags den Auftrag zur Reparatur erteilen, entfallen die Kostenvorschlagskosten. An unseren Kostenvorschlag sind wir zwei Wochen ab Ausstellungsdatum gebunden. Für eine schnelle Abwicklung Ihres Servicefalls legen Sie bitte eine ausführliche Fehlerbeschreibung und ihre Adressdaten der Einsendung bei.

Falls ein zurückgesandtes, defektes Produkt von LRP nicht mehr produziert wird, und wir dieses nicht reparieren können, so erhalten Sie statt dessen ein mindestens gleichwertiges Produkt aus einer der Nachfolgeserien.

Die von LRP angegebenen Werte über Gewicht, Größe oder Sonstiges sind als Richtwert zu verstehen. LRP übernimmt keine formelle Verpflichtung für derartige spezifische Angaben, da sich durch technische Veränderungen, die im Interesse des Produkts vorgenommen werden, andere Werte ergeben können.

Bei LRP 25 Jahre Garantie Produkten gelten zusätzlich die Garantiebestimmungen auf der LRP 25 Jahre Garantiekarte. Die ursprünglichen beim Kauf des Produktes entstehenden gesetzlichen Gewährleistungsansprüche gegenüber dem Verkäufer sowie zwingende gesetzliche Haftungsregelungen nach dem Produkthaftungsgesetz bleiben hiervon unberührt.

LRP-Works-Service:

- Produkt mit Kaufbeleg und Fehlerbeschreibung bruchsticher verpacken.
- Einsenden an: LRP electronic GmbH – Serviceabteilung
Wilhelm-Enssle-Str. 132-134, 73630 Remshalden, Deutschland
- LRP repariert das Produkt.
- Rücksendung an Sie per Nachnahme.

Technik + Service Hotline:

D: 0900 577 4624 (0900 LRP GMBH) (0.49€/Minute aus dem dt. Festnetz. Mobilfunkpreise können abweichen)
A: 0900 270 313 (0.73€/Minute aus dem öst. Festnetz. Mobilfunkpreise können abweichen)
eMail: service@lrp-electronic.de
Web: www.LRP.cc

REPAIR PROCEDURES / LIMITED WARRANTY

All products from LRP electronic GmbH (hereinafter called "LRP") are manufactured according to the highest quality standards. LRP guarantees this product to be free from defects in materials or workmanship for 90 days (non-european countris only) from the original date of purchase verified by sales receipt. This limited warranty doesn't cover defects, which are a result of misuse, improper maintenance, outside interference or mechanical damage.

„This applies among other things on:

- Cut off original power plug or not using reverse polarity protected plugs
- Receiver wire and/or switch wire damaged
- Mechanical damage of the case
- Humidity/Water inside the speed control
- Mechanical damage of electronic components/PCB
- Soldered on the PCB (except on external solder-tabs)
- Connected speed-control with reversed polarity“

To eliminate all other possibilities or improper handling, first check all other components in your model and the trouble shooting guide, if available, before you send in this product for repair. If products are sent in for repair, which do operate perfectly, we have to charge a service fee according to our pricelist.

With sending in this product, the customer has to advise LRP if the product should be repaired in either case. If there is neither a warranty nor guarantee claim, the inspection of the product and the repairs, if necessary, in either case will be charged with a fee at the customers expense according to our price list. A proof of purchase including date of purchase needs to be included. Otherwise, no warranty can be granted. For quick repair- and return service, add your address and detailed description of the malfunction.

If LRP no longer manufactures a returned defective product and we are unable to service it, we shall provide you with a product that has at least the same value from one of the successor series.

The specifications like weight, size and others should be seen as guide values. Due to ongoing technical improvements, which are done in the interest of the product, LRP does not take any responsibility for the accuracy of these specs.

With LRP 25-Years Warranty products, the warranty terms on the LRP 25-Years Warranty card do also apply. The legal warranty claims, which arose originally when the product was purchased, shall remain unaffected.

LRP-Distributor-Service:

- Package your product carefully and include sales receipt and detailed description of malfunction.
- Send parcel to your national LRP distributor.
- Distributor repairs or exchanges the product.
- Shipment back to you usually by COD (cash on delivery), but this is subject to your national LRP distributor's general policy.