





BAUABSCHNITTE CONSTRUCTION SECTIONS

1 FRONT SUSPENSION VORDERACHSE

	Ball Stud (long) #124027	2x
	M3 x 10 #133086	2x
	Nylon Nut M3 #133073	2x
	Washer 3 x 7 x 2	2x
	M2.5 x 5 #124048	2x

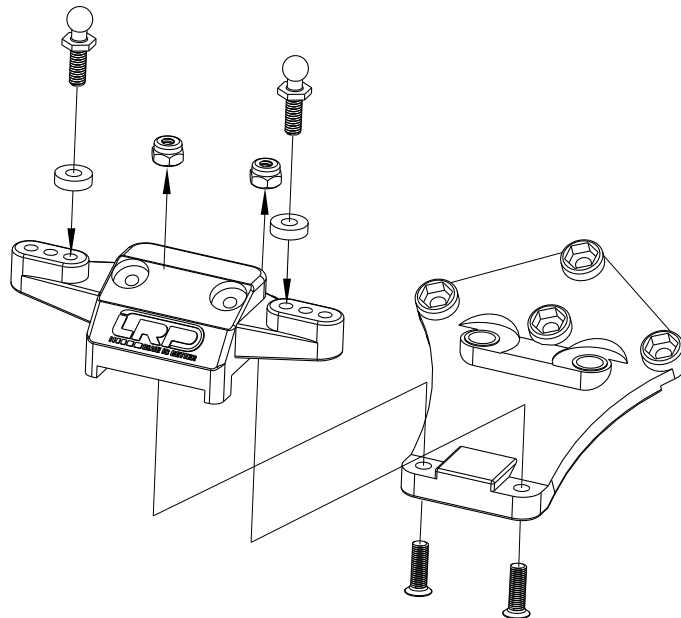

2 FRONT SUSPENSION VORDERACHSE

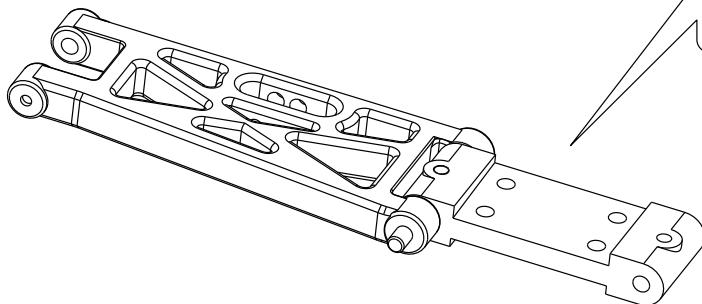

Auf Einbaurichtung achten
Standard 30°, Option 25°

Note the direction
Standard 30°, Option 25°

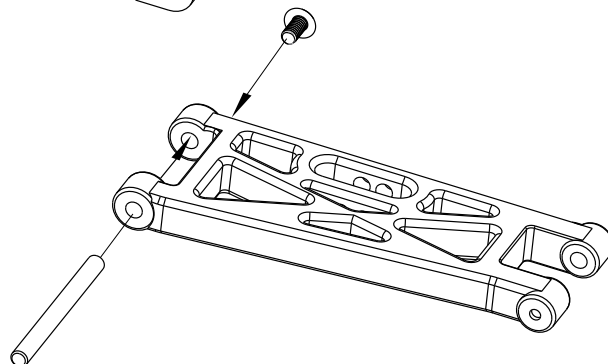
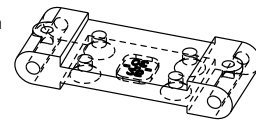



BAUABSCHNITTE CONSTRUCTION SECTIONS

3

FRONT SUSPENSION
VORDERACHSE



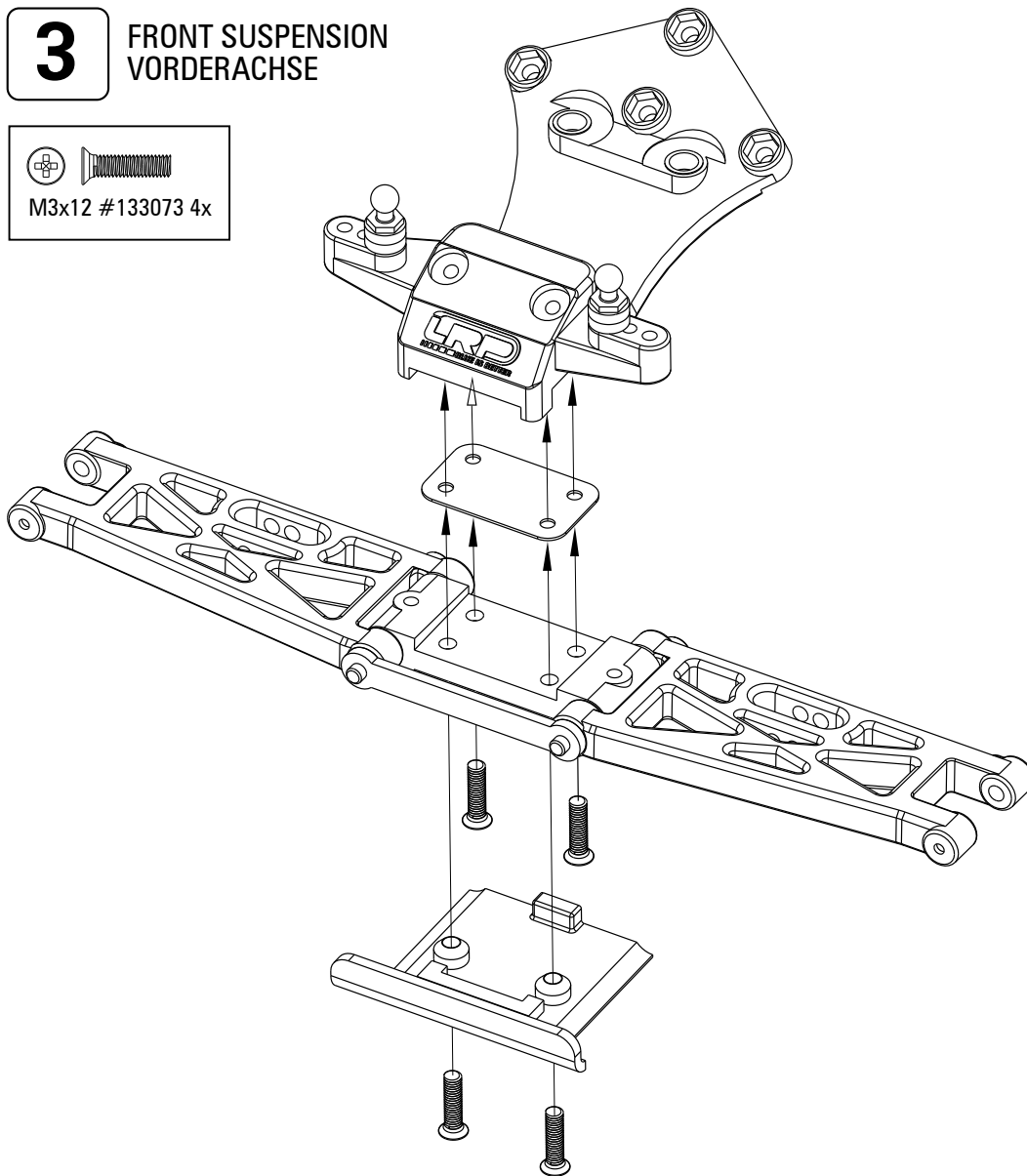

M3x12 #133073 4x

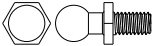

BAUABSCHNITTE CONSTRUCTION SECTIONS

4 STEERING LENKUNG

-  Ball Stud (short) #124028 3x
-  M3 x 6 #124063 4x

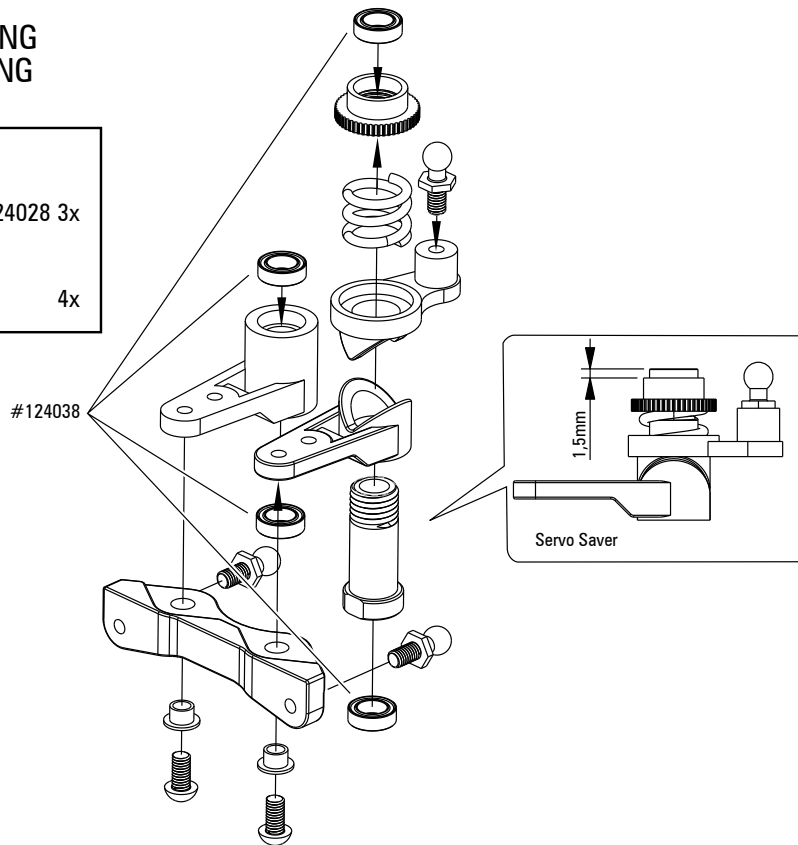

5 STEERING LENKUNG

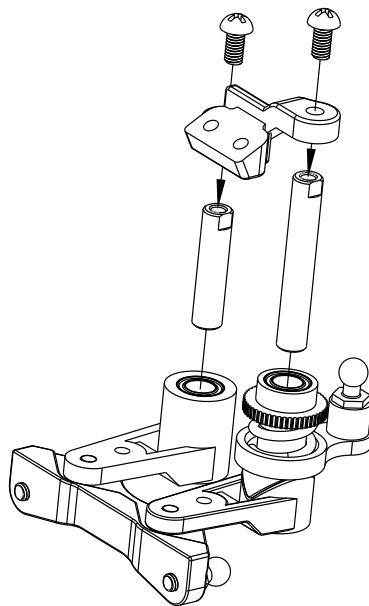











BAUABSCHNITTE CONSTRUCTION SECTIONS

6

ATTACHING FRONT SUSPENSION
EINBAU VORDERACHSE

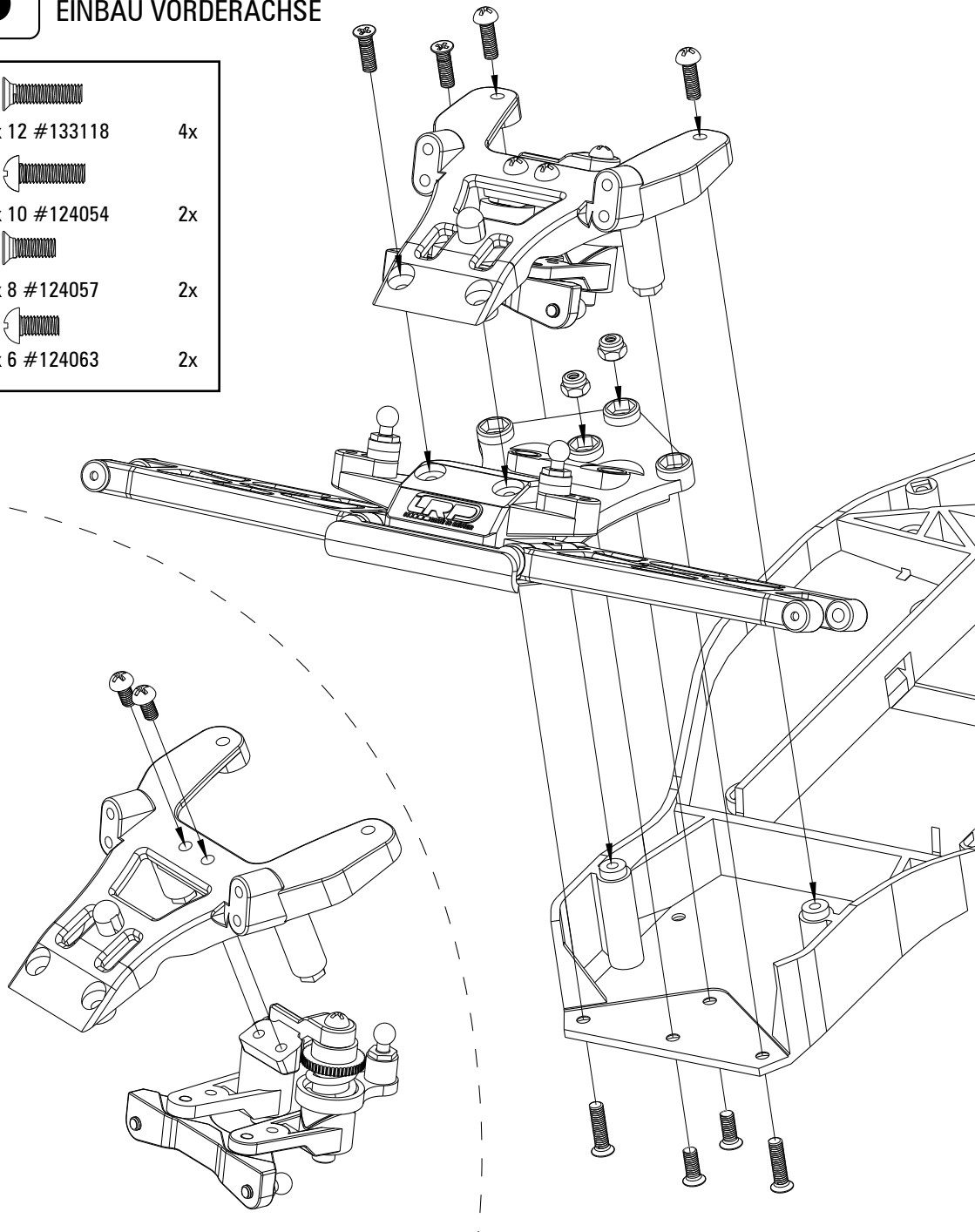

		
M3 x 12 #133118	4x	
		
M3 x 10 #124054	2x	
		
M3 x 8 #124057	2x	
		
M3 x 6 #124063	2x	



BAUABSCHNITTE CONSTRUCTION SECTIONS

7

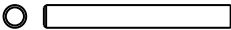
FRONT SUSPENSION
VORDERACHSE

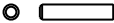
	Pin 3 x 25 #124031	2x
	Washer 3 x 7 x 2	2x
	M2.5 x 5 #124048	2x
	Pin 2 x 10 #124041	2x

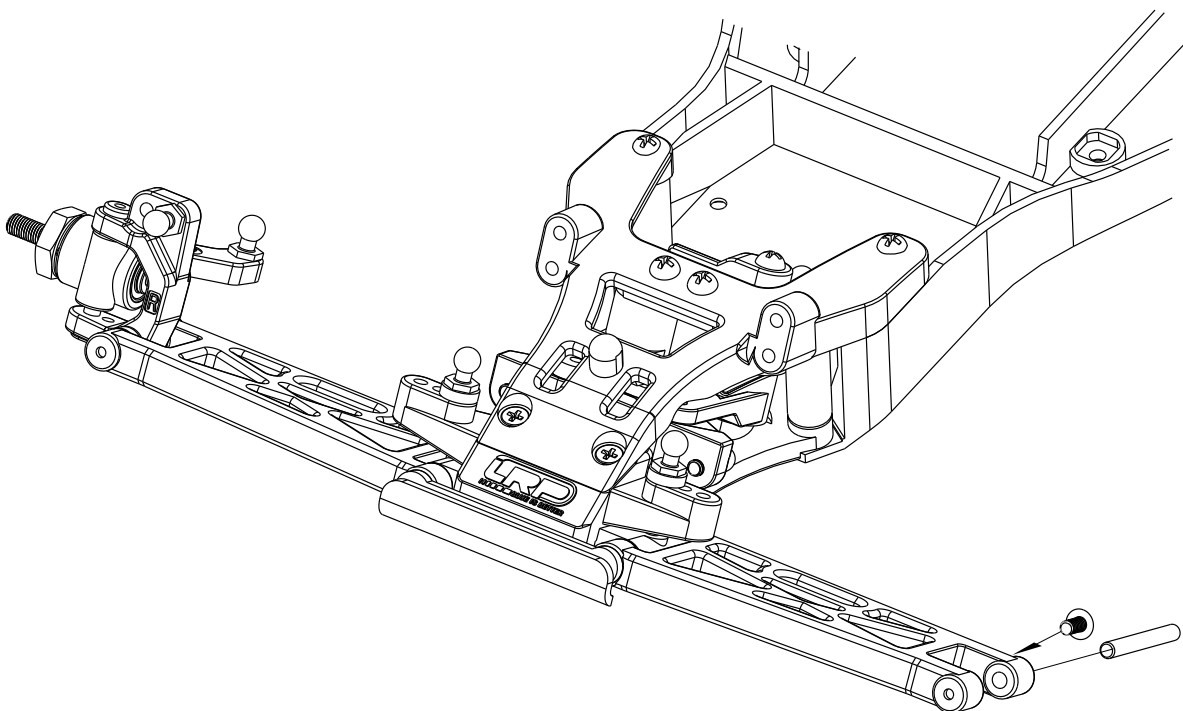
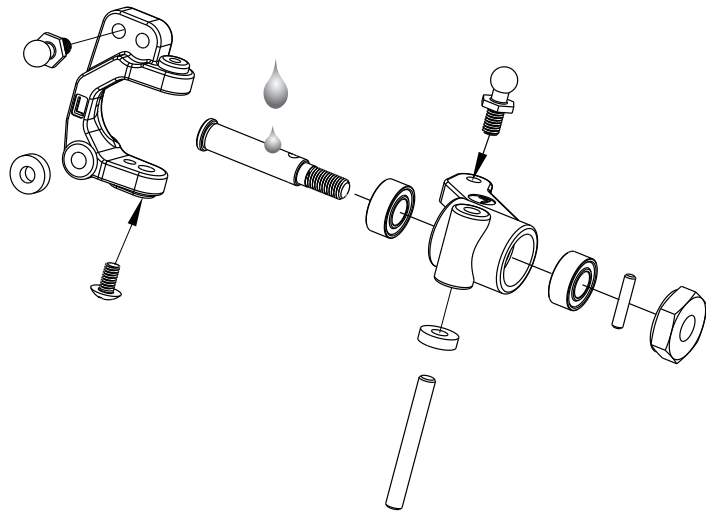

BAUABSCHNITTE CONSTRUCTION SECTIONS

8

FRONT SUSPENSION
EINBAU OBERE QUERLENKER UND SPURSTANGEN

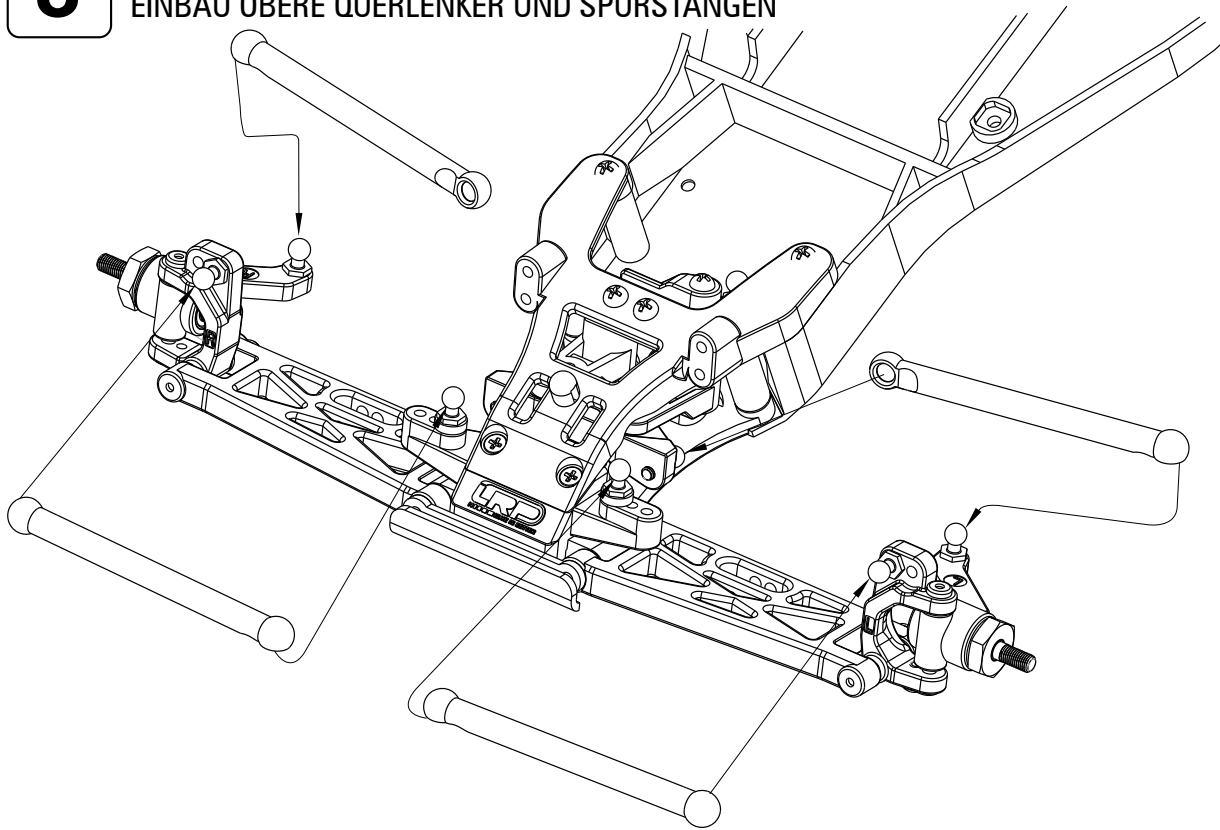

9

FRONT SHOCK TOWER
VORDERE DÄMPFERBRÜCKE



M3 x 26 #124055 2x



M3 x 10 #124054 4x



Nut M3 #124059 2x

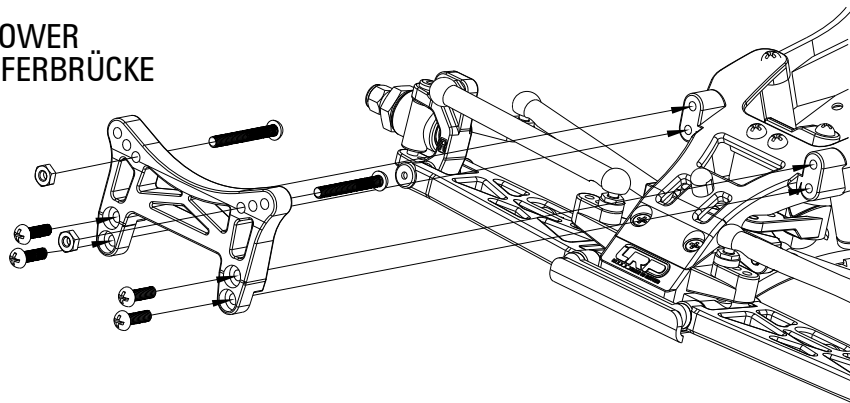

BAUABSCHNITTE CONSTRUCTION SECTIONS

10 DIFFERENTIAL GEAR KEGELDIFFERENTIAL

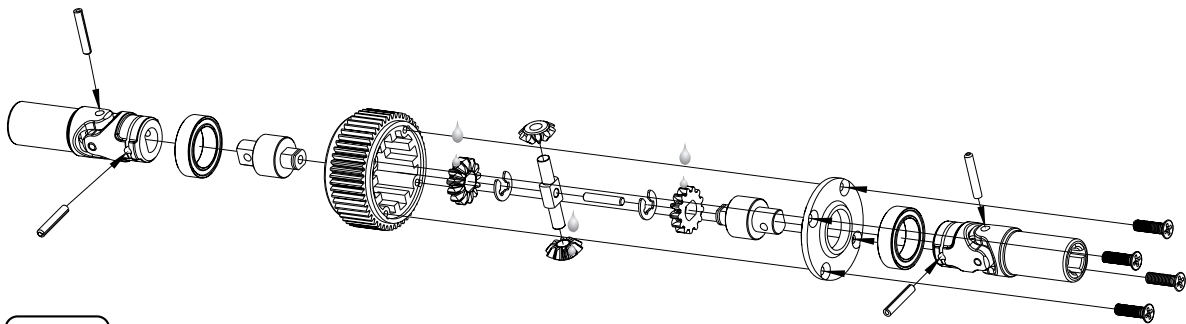
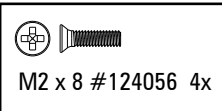

11 TRANSMISSION GETRIEBE

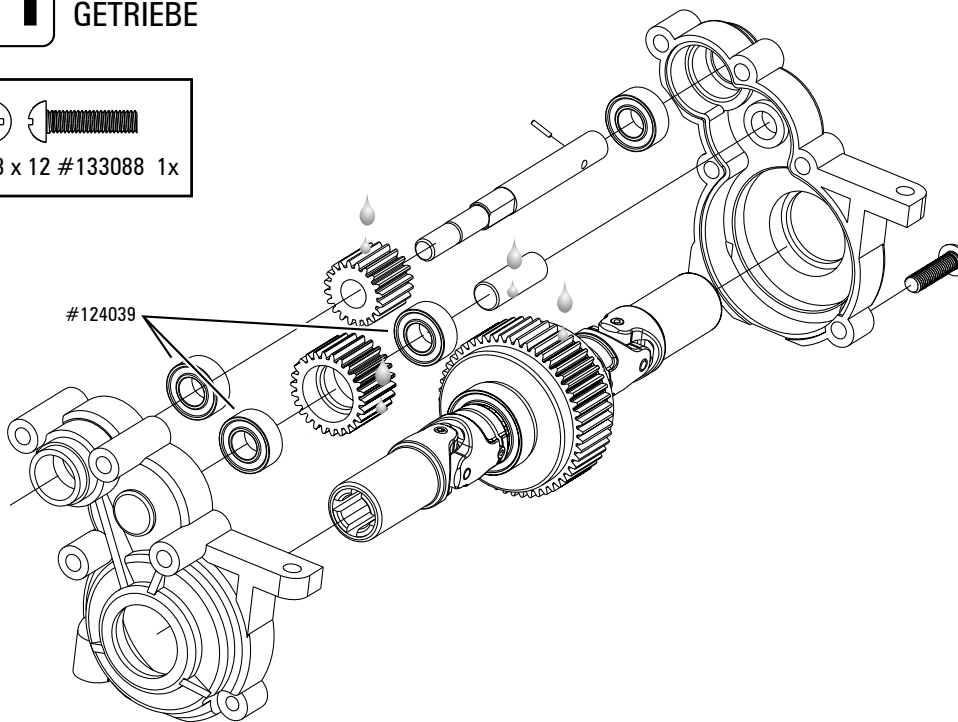
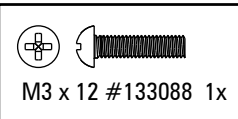



BAUABSCHNITTE CONSTRUCTION SECTIONS

12 MOTOR MOUNT MOTOR PLATTE



M3 x 26 #124055 x4

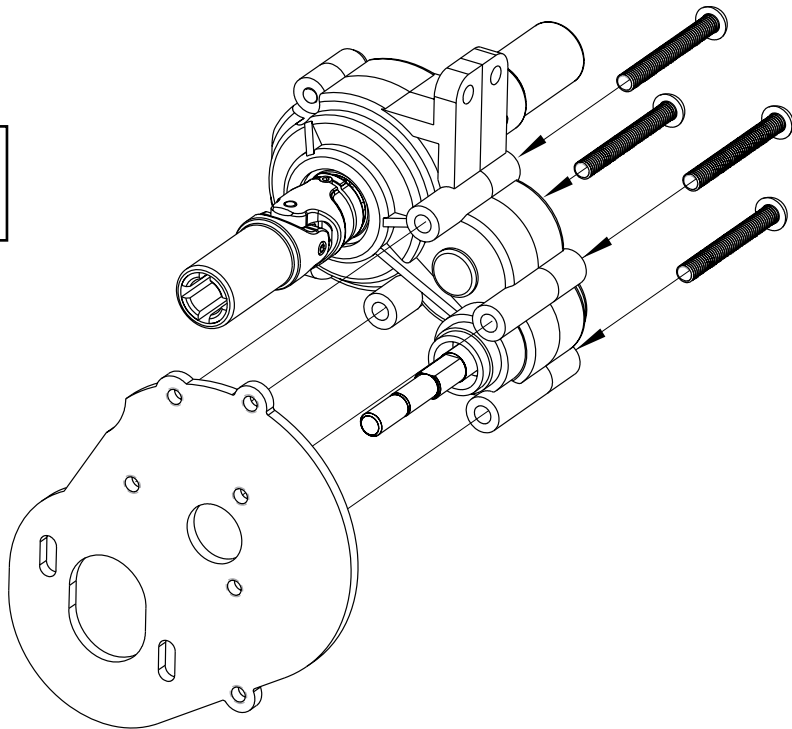

13 SLIPPER UNIT SLIPPER EINHEIT

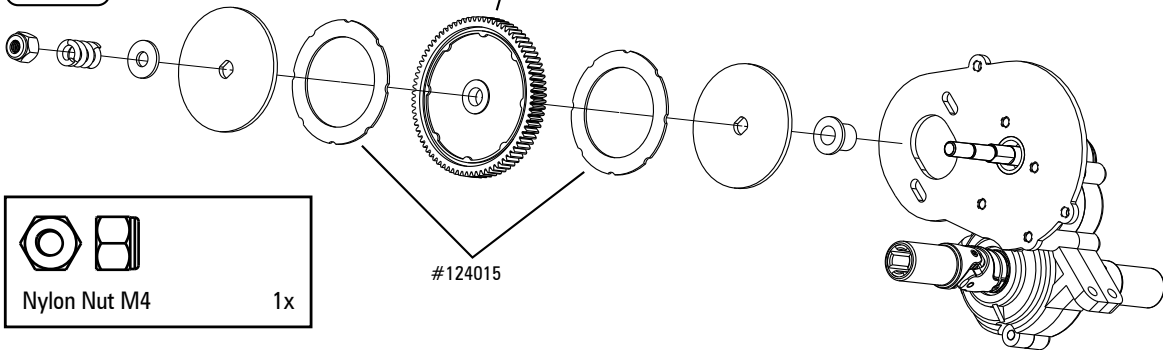







Nylon Nut M4

1x



BAUABSCHNITTE CONSTRUCTION SECTIONS

14 REAR SHOCK TOWER HINTERE DÄMPFERBRÜCKE

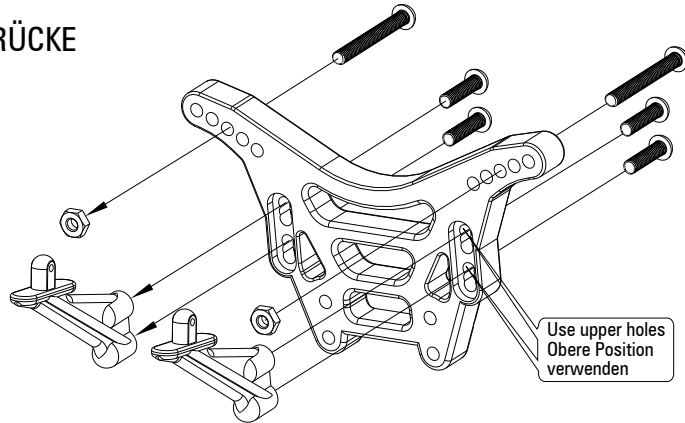
		
M3 x 26		2x
		
M3 x 12 #133088		4x
		
Nut M3 #124059		2x

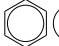
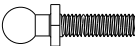

15 REAR UPPER DECK HINTERES OBERES DECK

		
Ball Stud long #124027		2x
		
Washer 3 x 7 x 2		2x

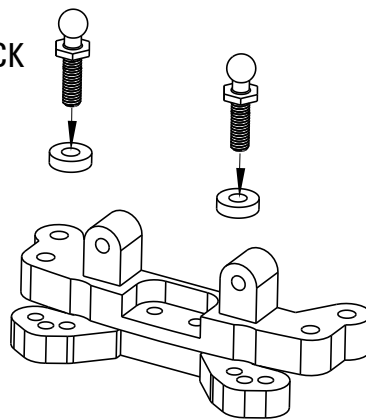



BAUABSCHNITTE CONSTRUCTION SECTIONS

16 ATTACHING REAR UPPER DECK MONTAGE DES HINTEREN, OBEREN DECKS

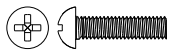

M3 x 12 #133088 4x

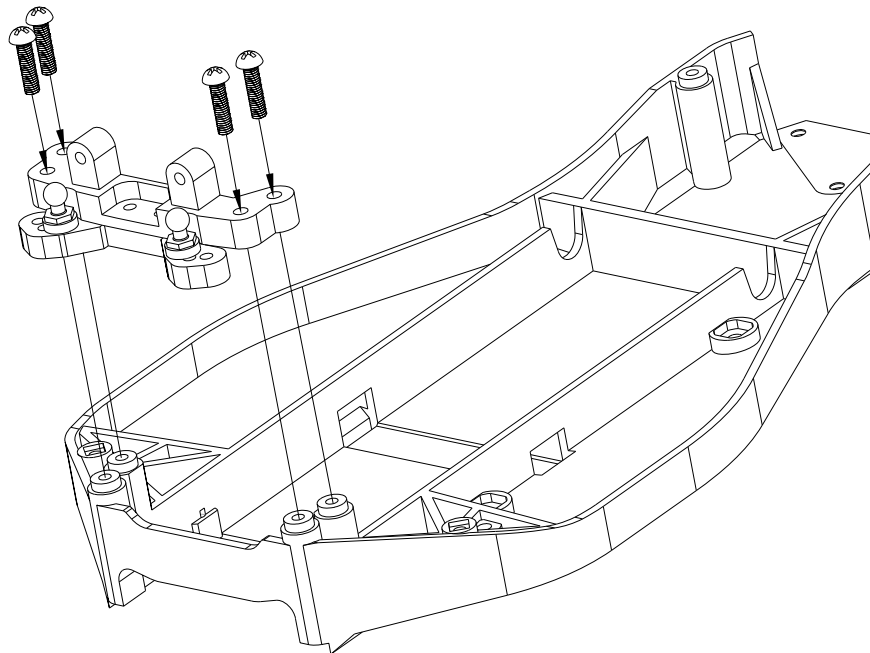

17 REAR LOWER DECK HINTERE UNTERE CHASSISPLATTE



M3 x 8 #124057 2x

Please note the correct mounting direction.
Bitte auf korrekte Einbaurichtung achten.

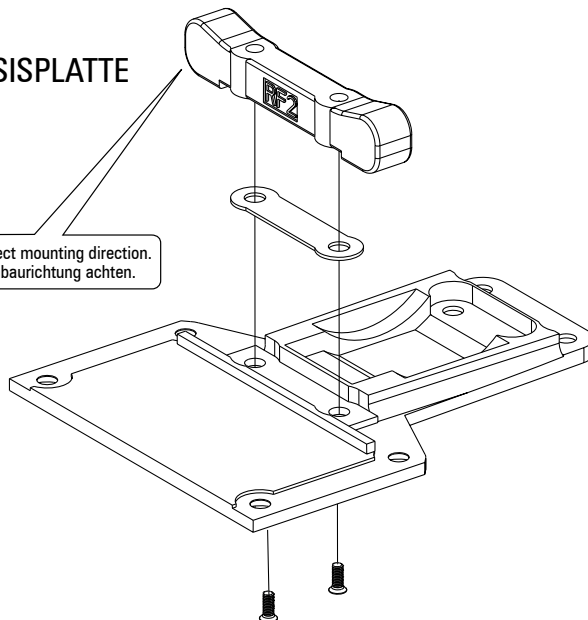

BAUABSCHNITTE CONSTRUCTION SECTIONS

18 REAR SUSPENSION HINTERACHSE



M3 x 10 #133086 2x



Hinge Pin 3 x 34 #124031 2x

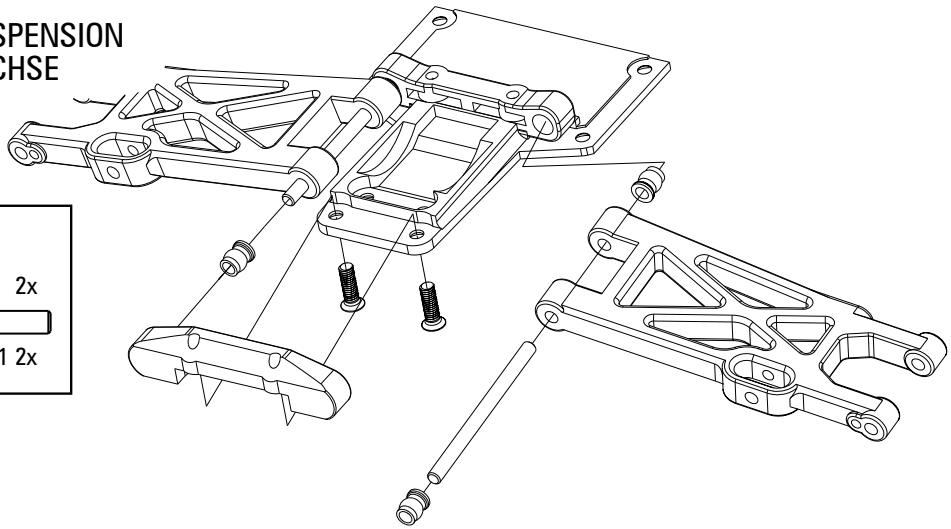

19 MAIN CHASSIS CHASSIS



M3 x 10 #133086 4x

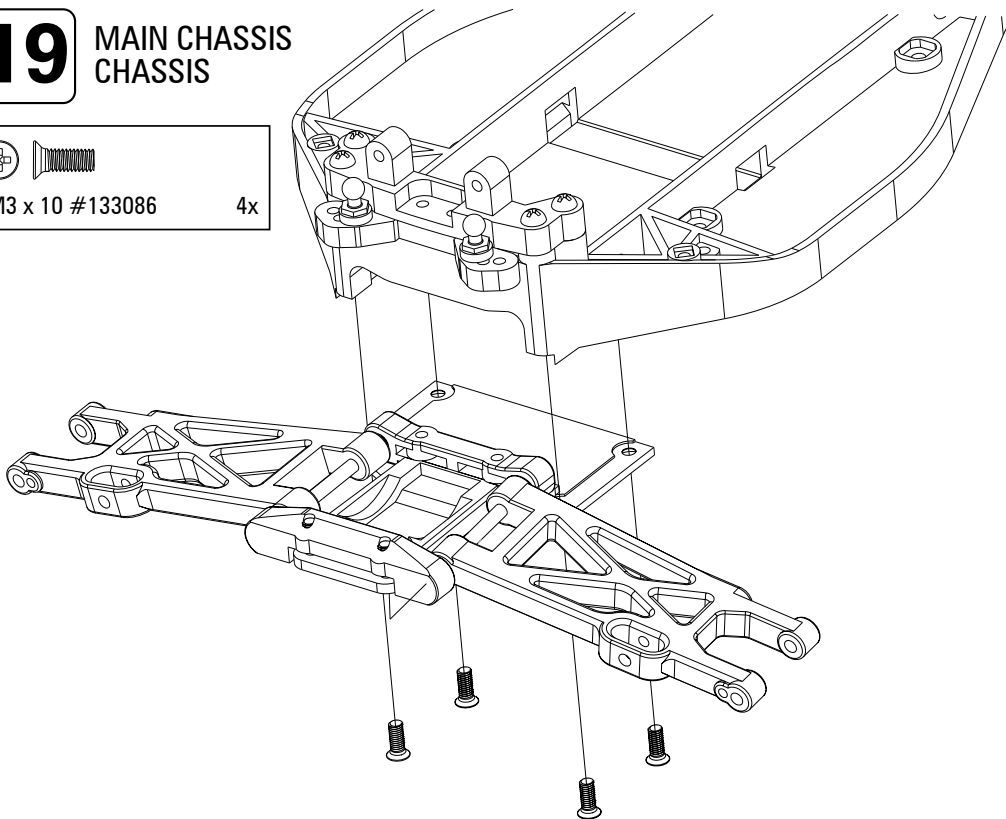



BAUABSCHNITTE CONSTRUCTION SECTIONS

20 REAR GEARBOX ANTRIEBSEINHEIT

	M3 x 12 #133088	2x
	M3 x 10 #133086	2x

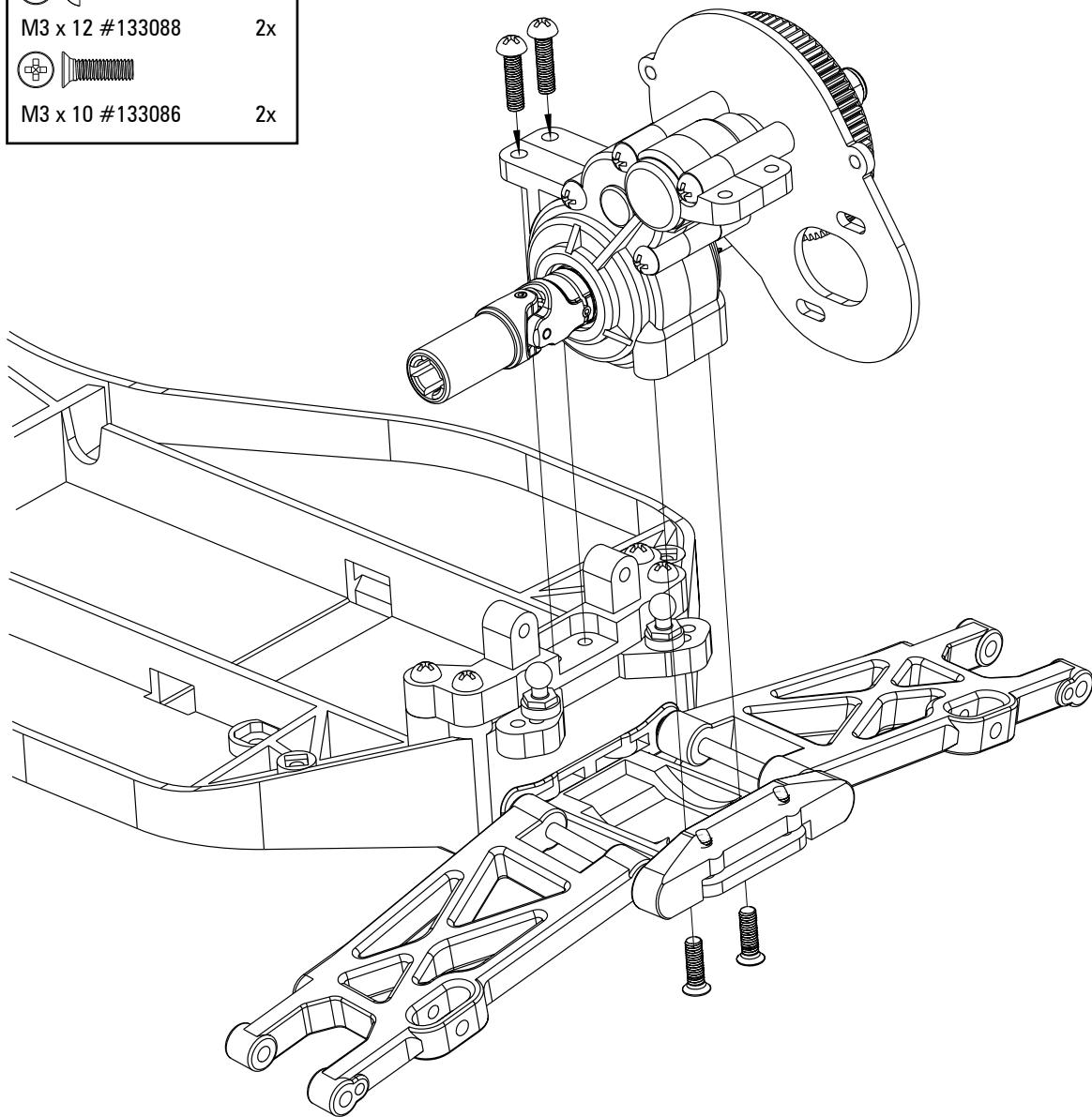

BAUABSCHNITTE CONSTRUCTION SECTIONS

21 REAR SHOCK STAY & MOTOR GUIDE MONTAGE DER HINTEREN DÄMPFERBRÜCKE & MOTORSCHUTZPLATTE

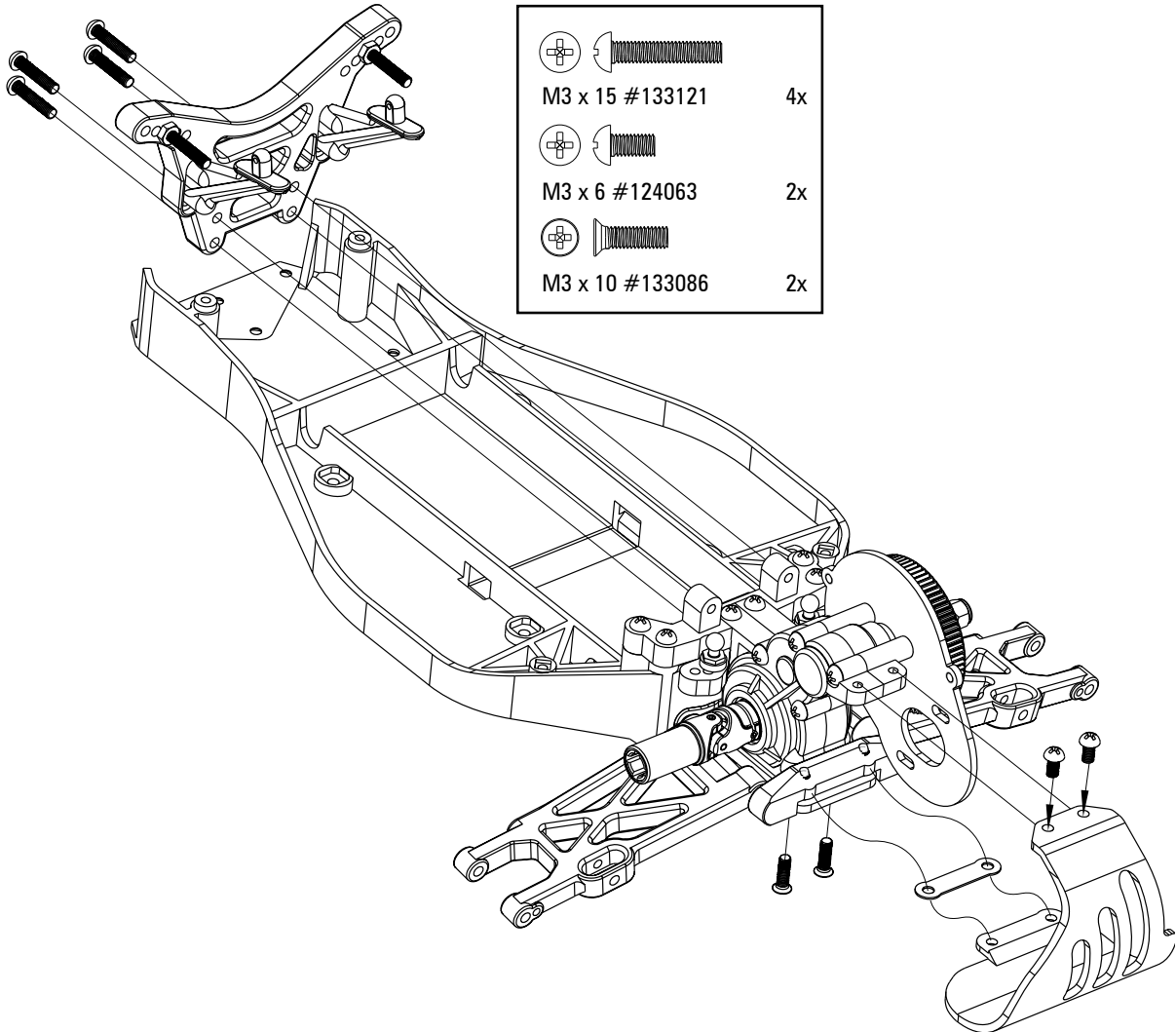



BAUABSCHNITTE CONSTRUCTION SECTIONS

22 REAR SUSPENSION HINTERACHSE

Washer 3 x 7 x 2		2x
Pin 2 x 10 #124041		2x
Ball Stud (medium) #124061		2x

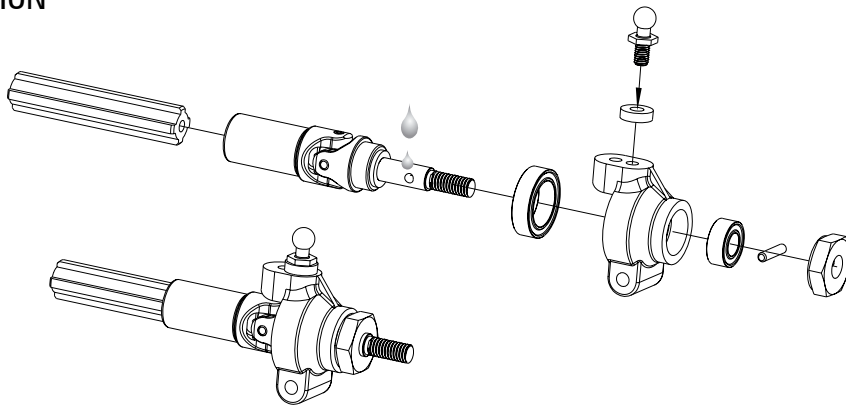

23 REAR SUSPENSION HINTERACHSE

M2.5 x 5 #124048		2x
Washer 3 x 6 x 2		2x
Hinge Pin 3 x 27 #124031		2x
Washer 3 x 6 x 0.8		2x

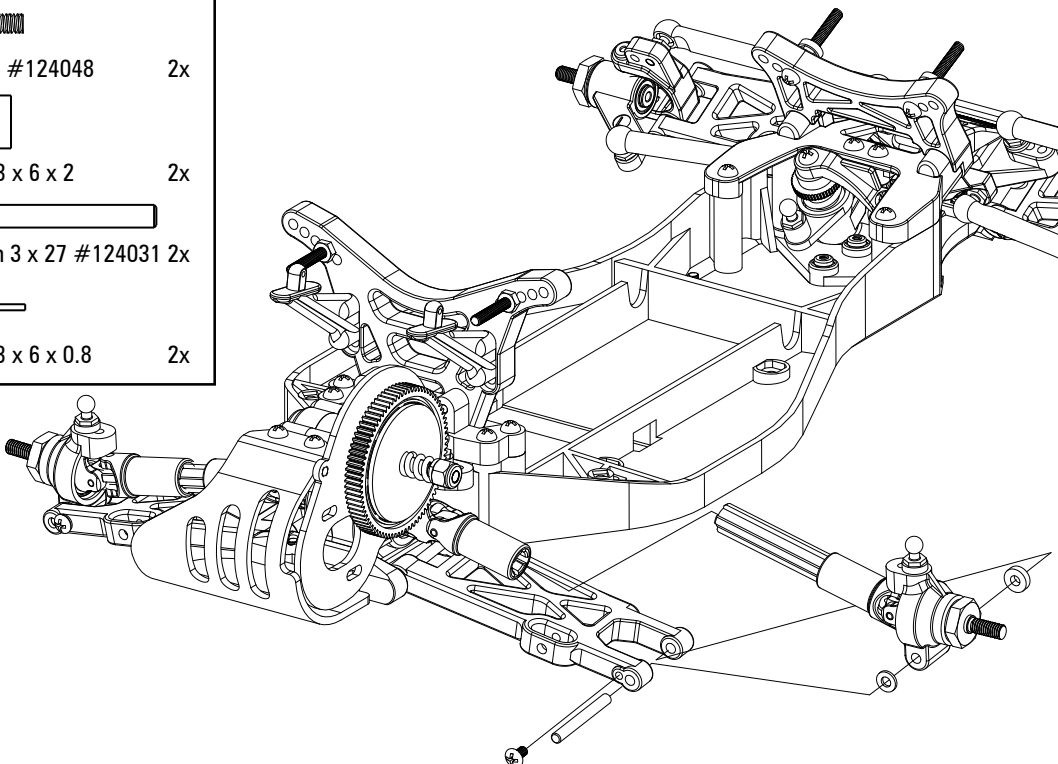

BAUABSCHNITTE CONSTRUCTION SECTIONS

24 REAR UPPER ARMS HINTERE OBERE QUERLENKER

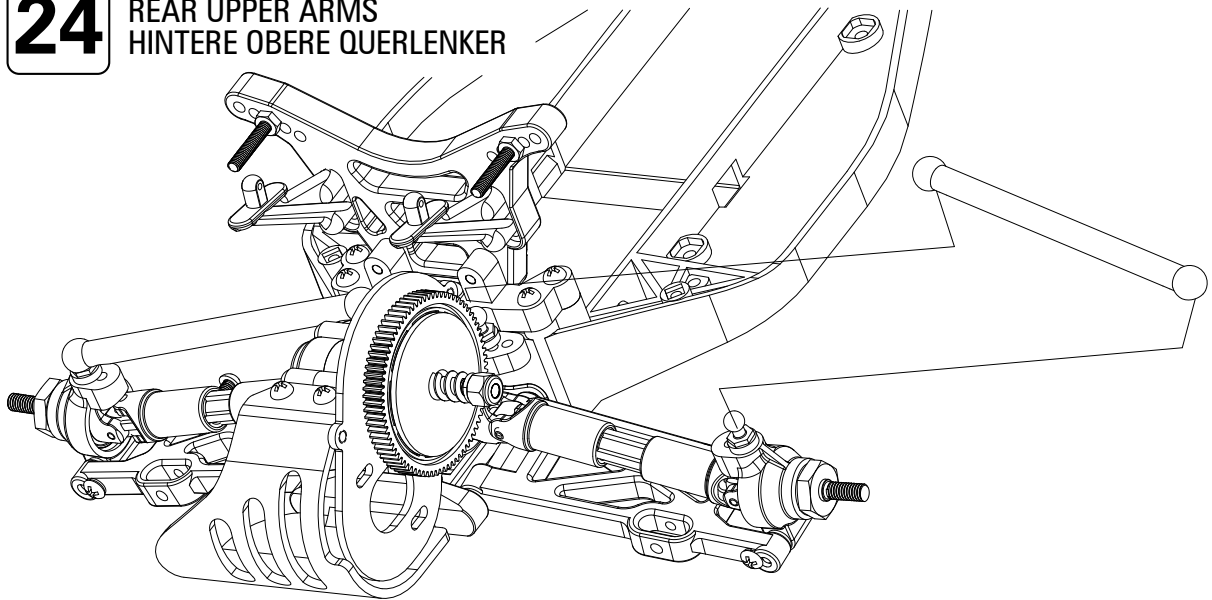

25 MAIN CHASSIS AKKU UND KAROSSERIEHALTER

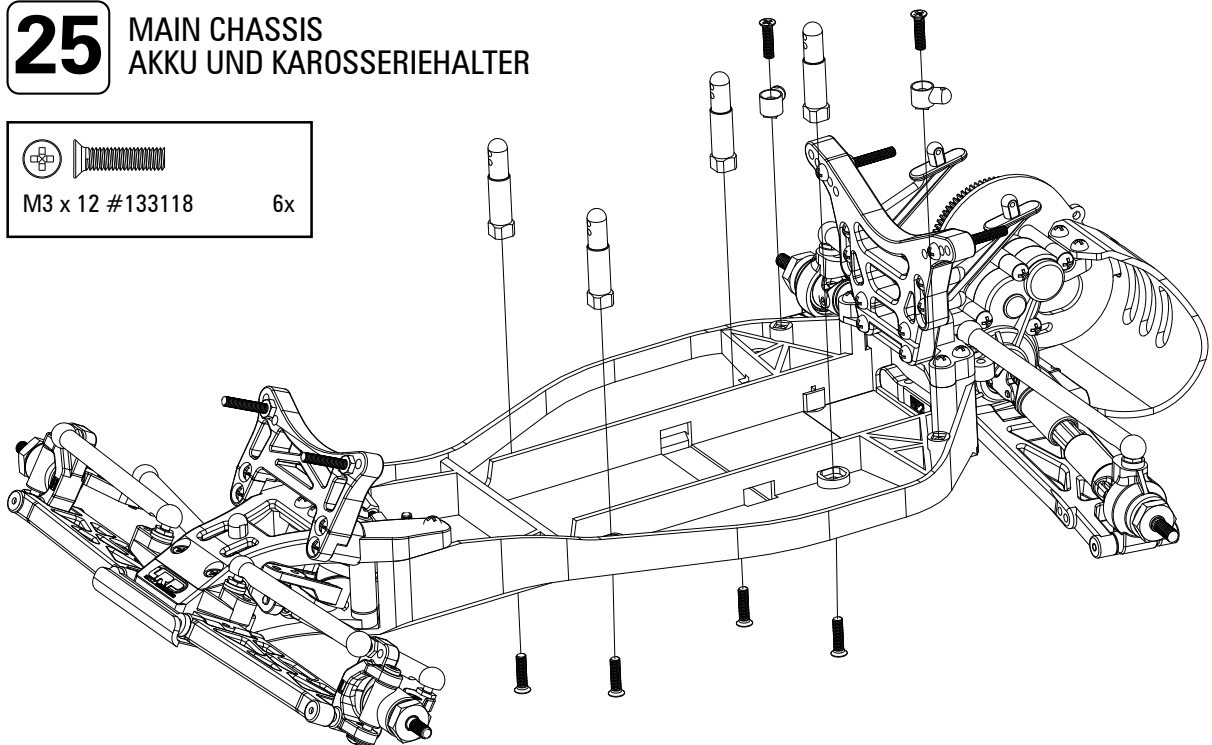
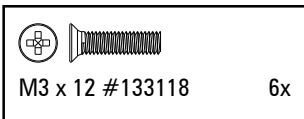



BAUABSCHNITTE CONSTRUCTION SECTIONS

26

SHOCKS
STOSSDÄMPFER

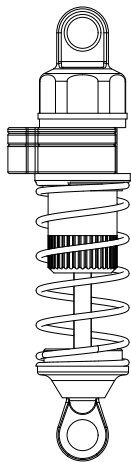
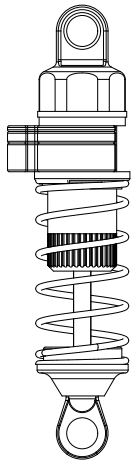

front shock (short)
vordere Stoßdämpfer (kurz)

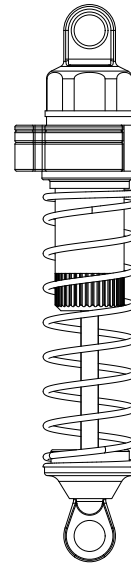
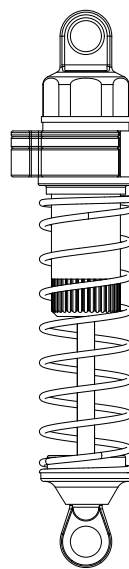
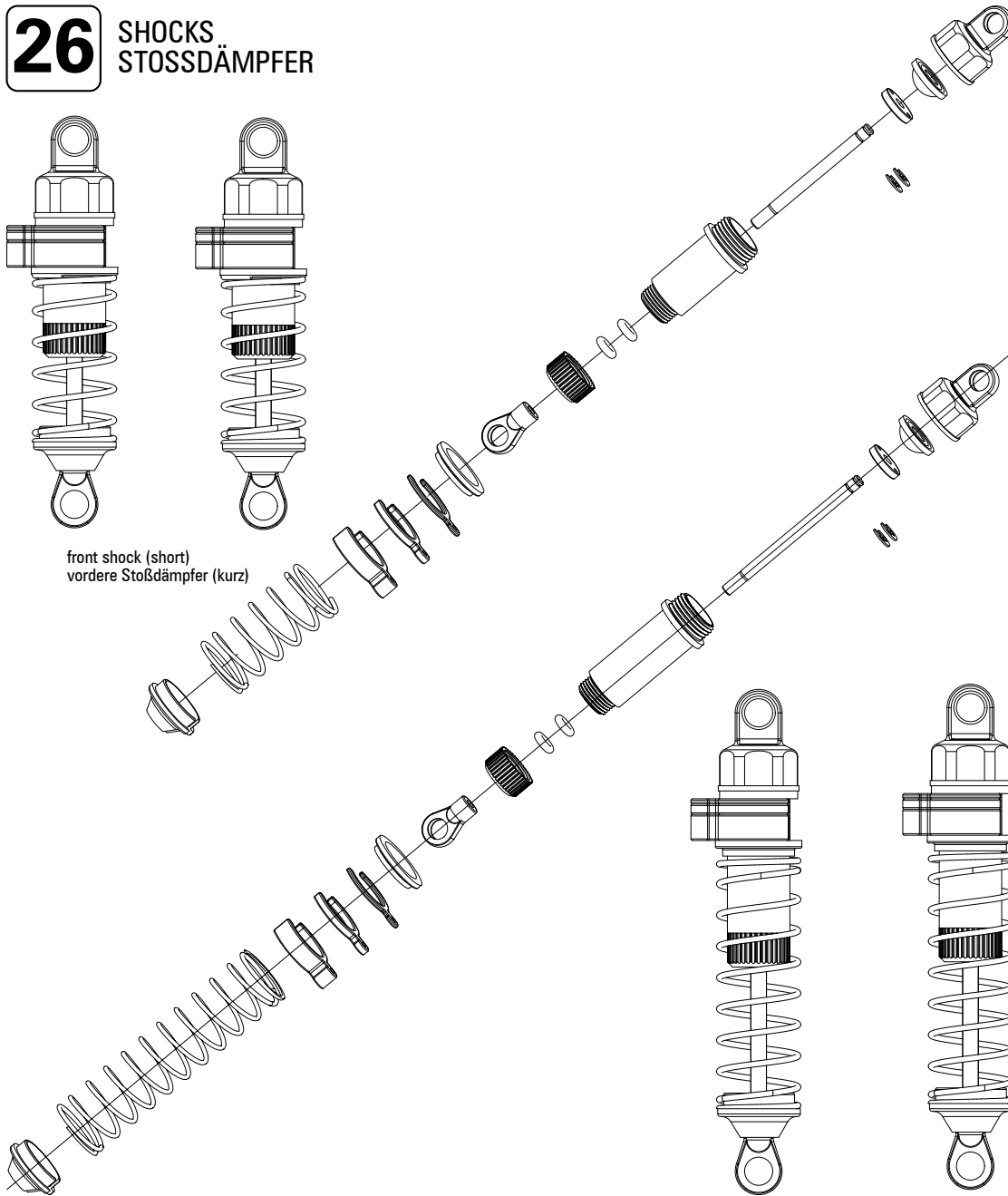

rear shock (long)
hintere Stoßdämpfer (lang)

BAUABSCHNITTE CONSTRUCTION SECTIONS

27 FRONT SUSPENSION BEFESTIGUNG DER VORDEREN DÄMPFER

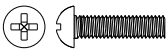
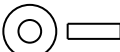
	
M3 x 12 #133088	2x
	
Washer 3 x 7 x 2	2x

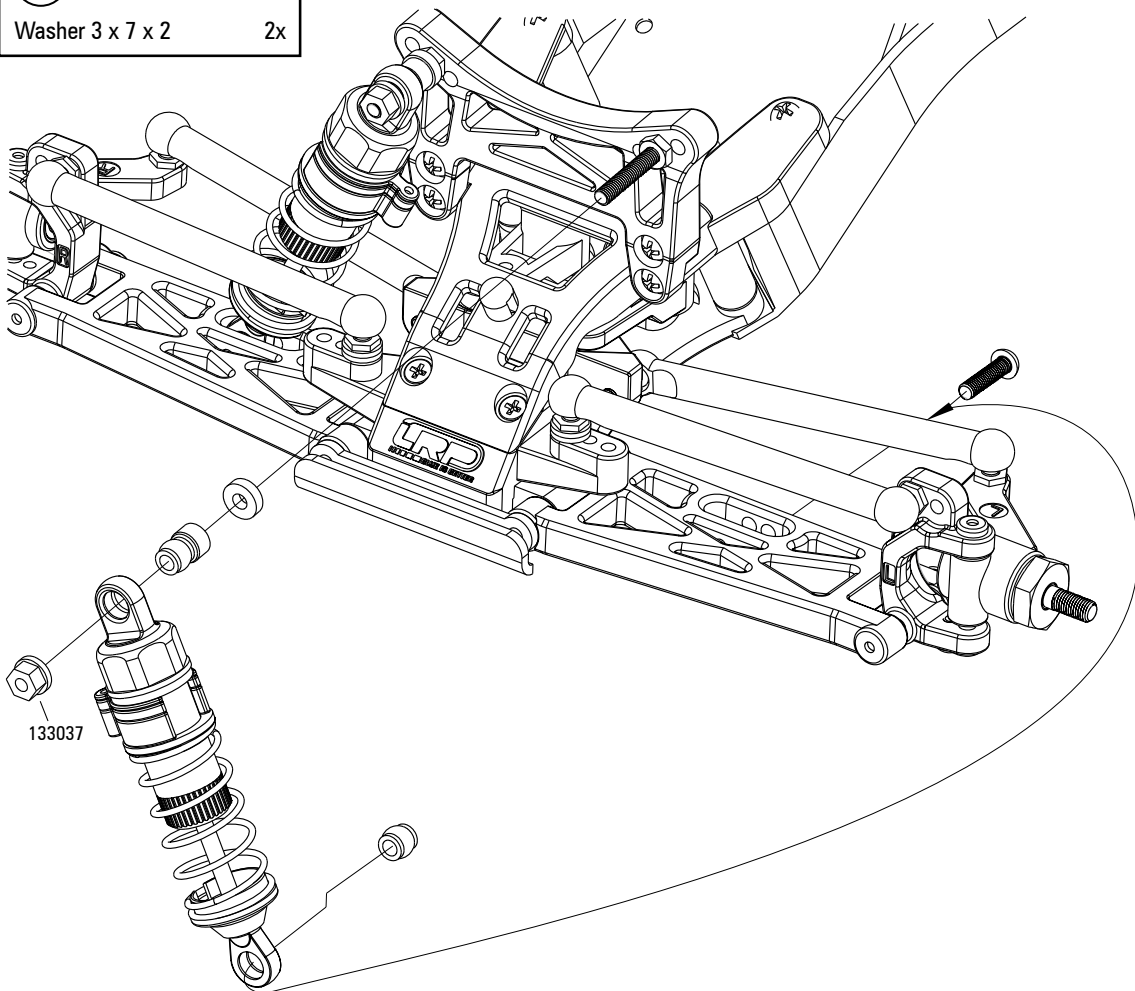



BAUABSCHNITTE CONSTRUCTION SECTIONS

28



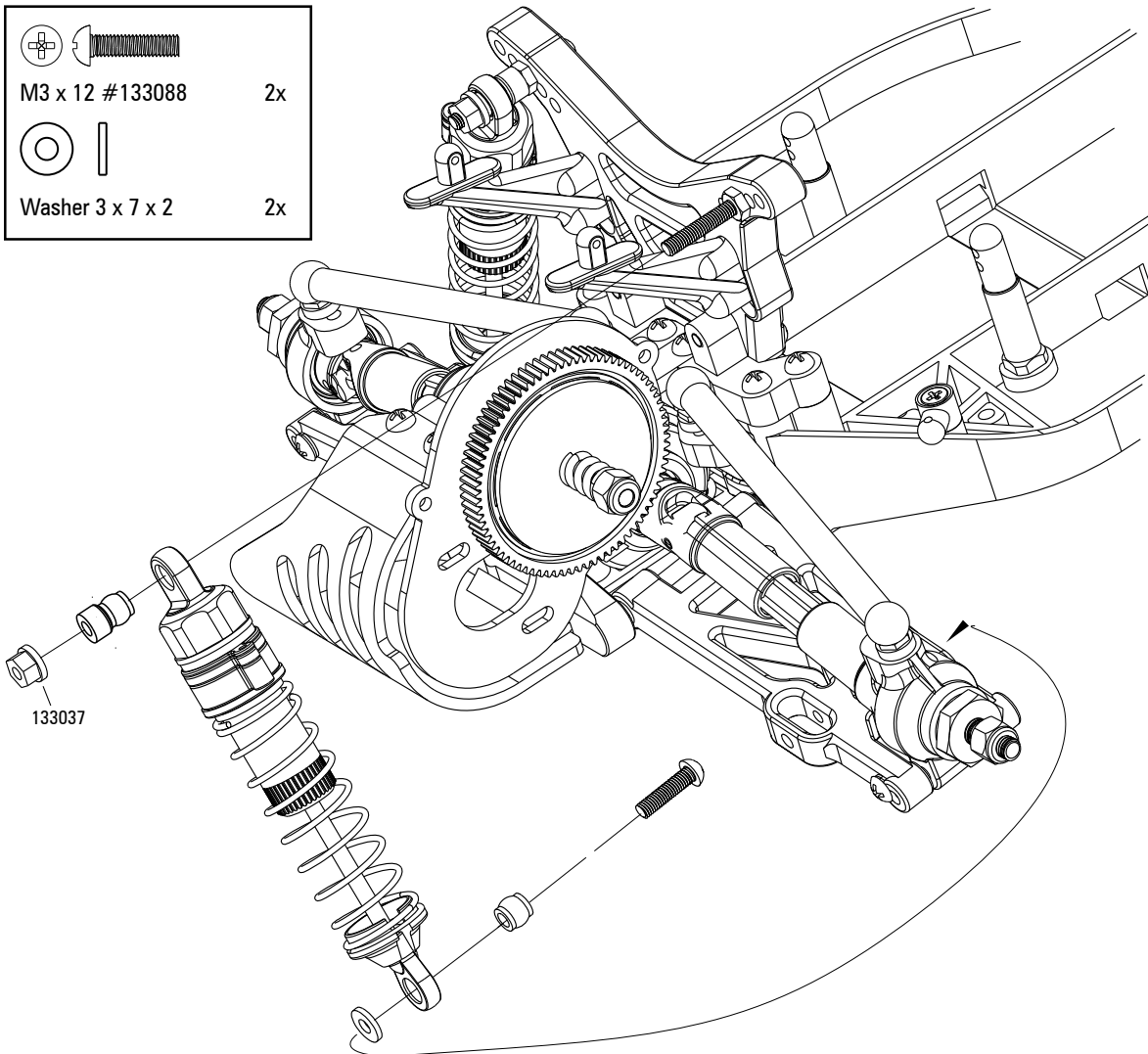

REAR SUSPENSION
BEFESTIGUNG DER HINTEREN DÄMPFER

	M3 x 12 #133088	2x
	Washer 3 x 7 x 2	2x

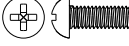

BAUABSCHNITTE CONSTRUCTION SECTIONS

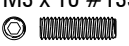
29 STEERING SERVO LENKSERVO



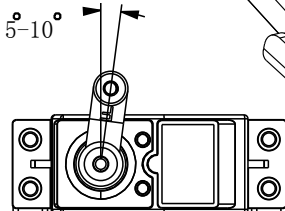
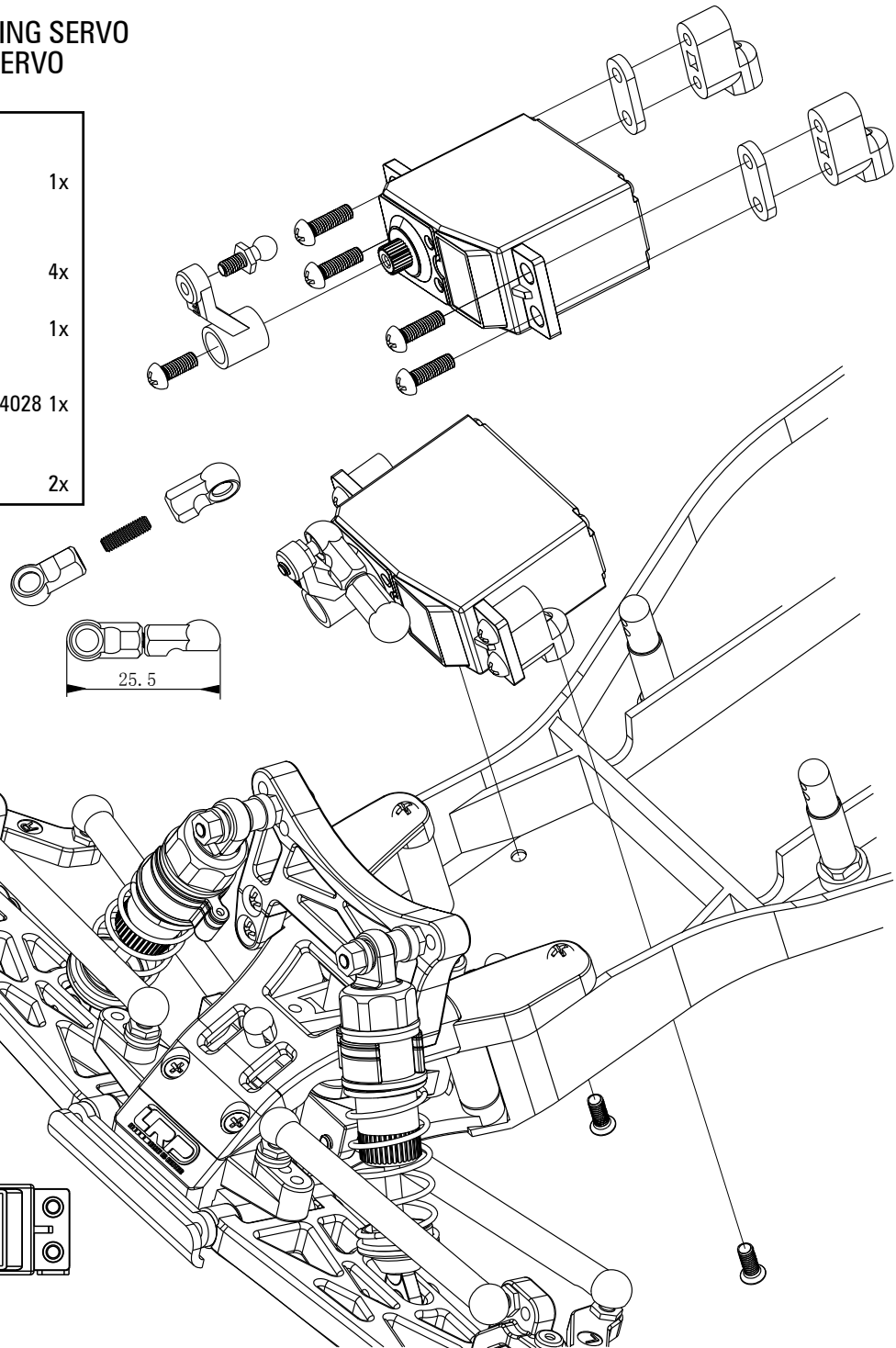

	M3 x 8 #124053	1x
	M3 x 10 #133086	4x
	M3 x 10 #124058	1x
	Ball Stud (short) #124028	1x
	M3 x 8 #124057	2x





BAUABSCHNITTE CONSTRUCTION SECTIONS

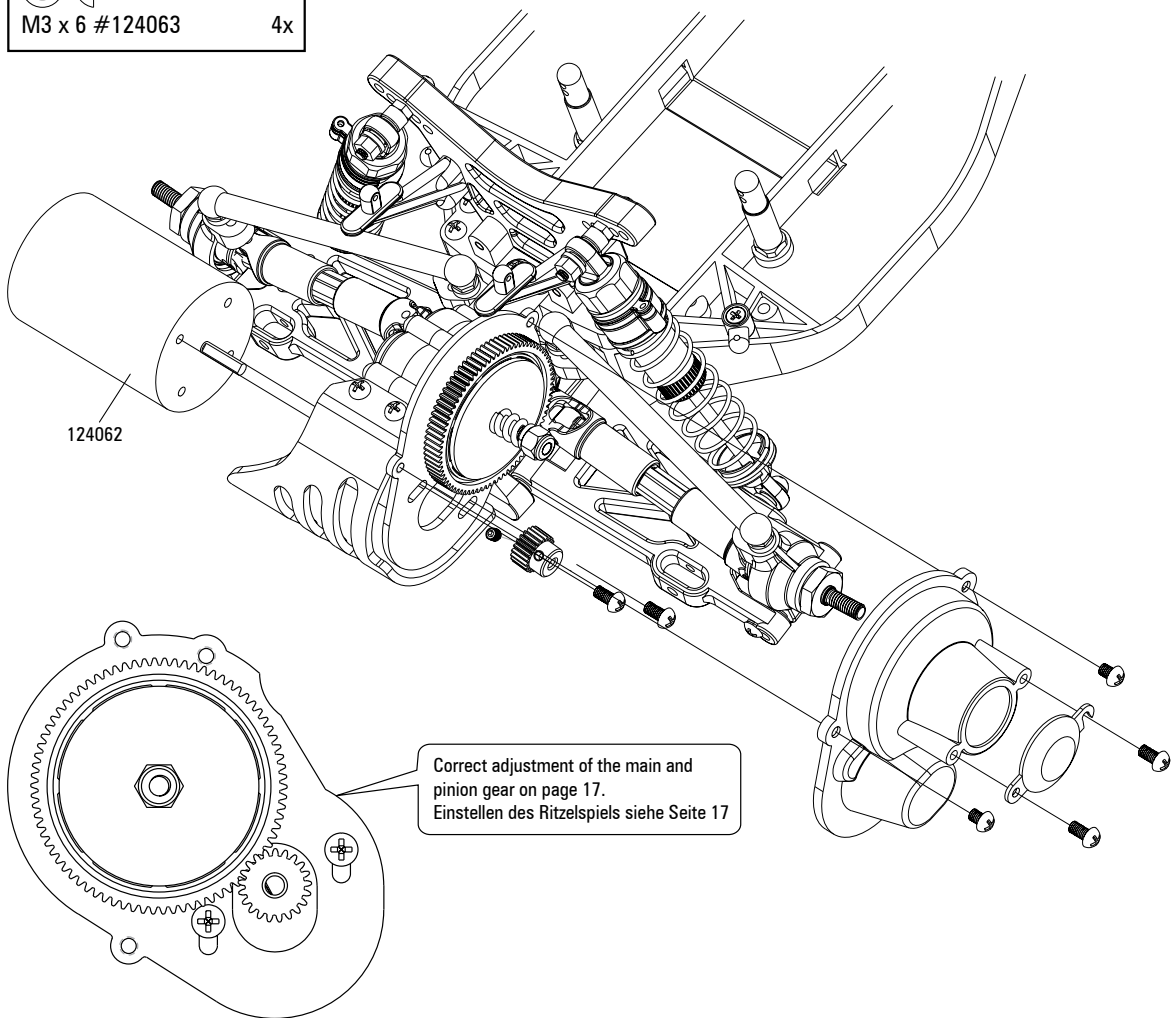

30 MOTOR MOTOR

		
M3 x 4 #124052	2x	
		
M3 x 6 #124063	4x	

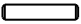

BAUABSCHNITTE CONSTRUCTION SECTIONS

31 TIRE WHEEL RADMONTAGE

		
Pin 2 x 10 #124041	4x	
		
Nylon Nut M4 #124060	4x	

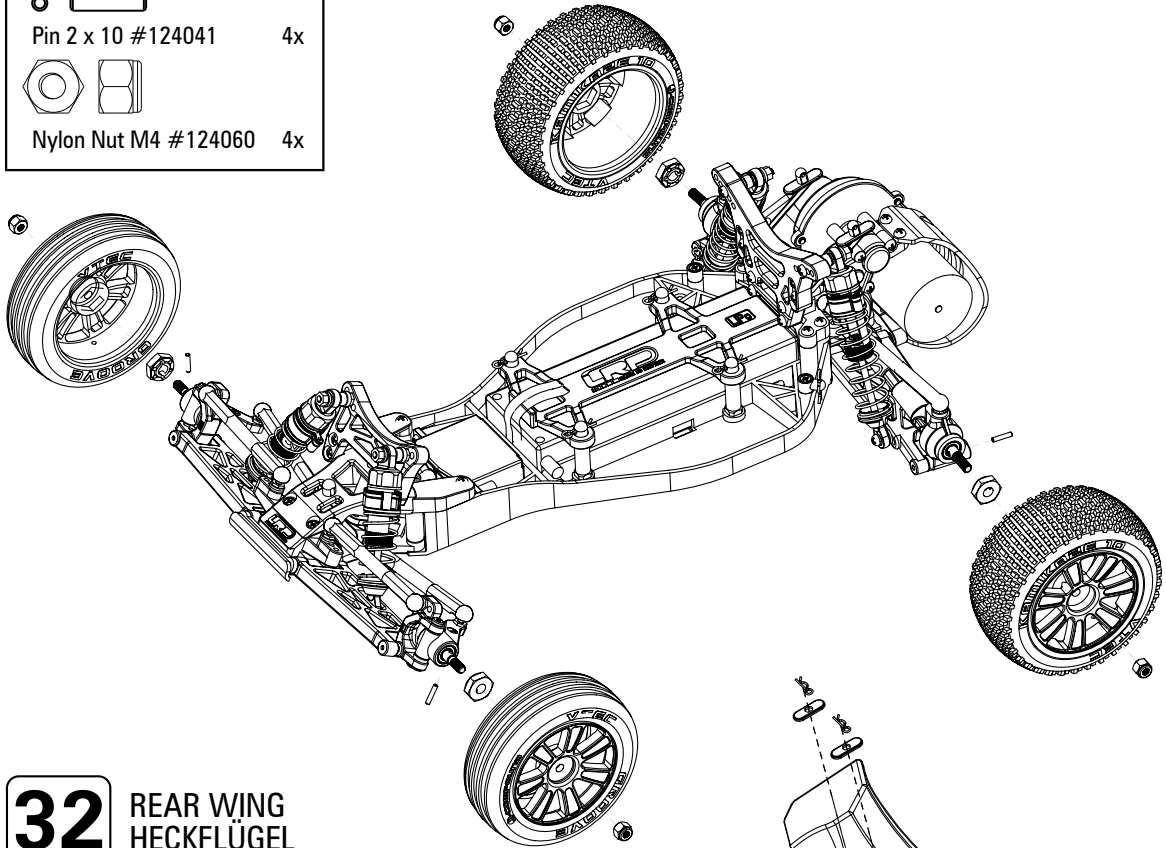

32 REAR WING HECKFLÜGEL

Bitte auf Einbaurichtung achten,
siehe Seite 85
Beware of the direction of the
washers. Please have a look on
page 85

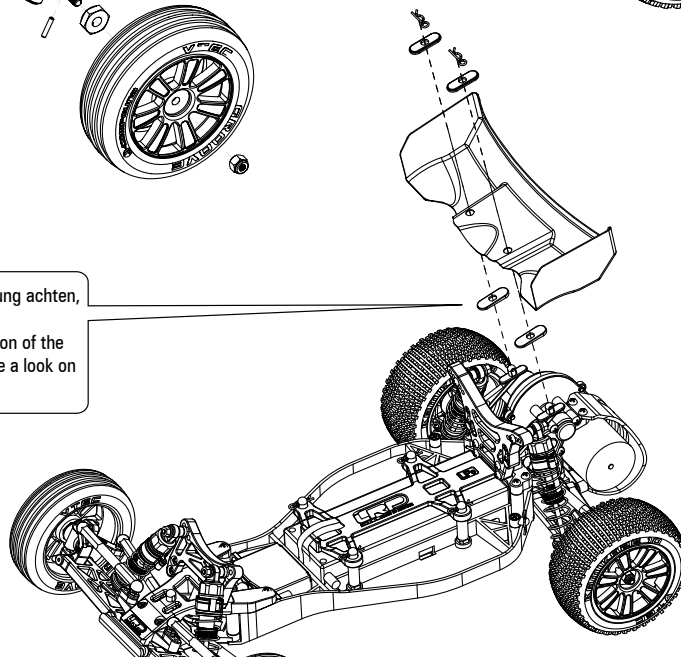



BAUABSCHNITTE CONSTRUCTION SECTIONS

33

ASSEMBLING OF THE ELECTRONIC COMPONENTS
EINBAU DER ELEKTRONISCHEN KOMPONENTEN

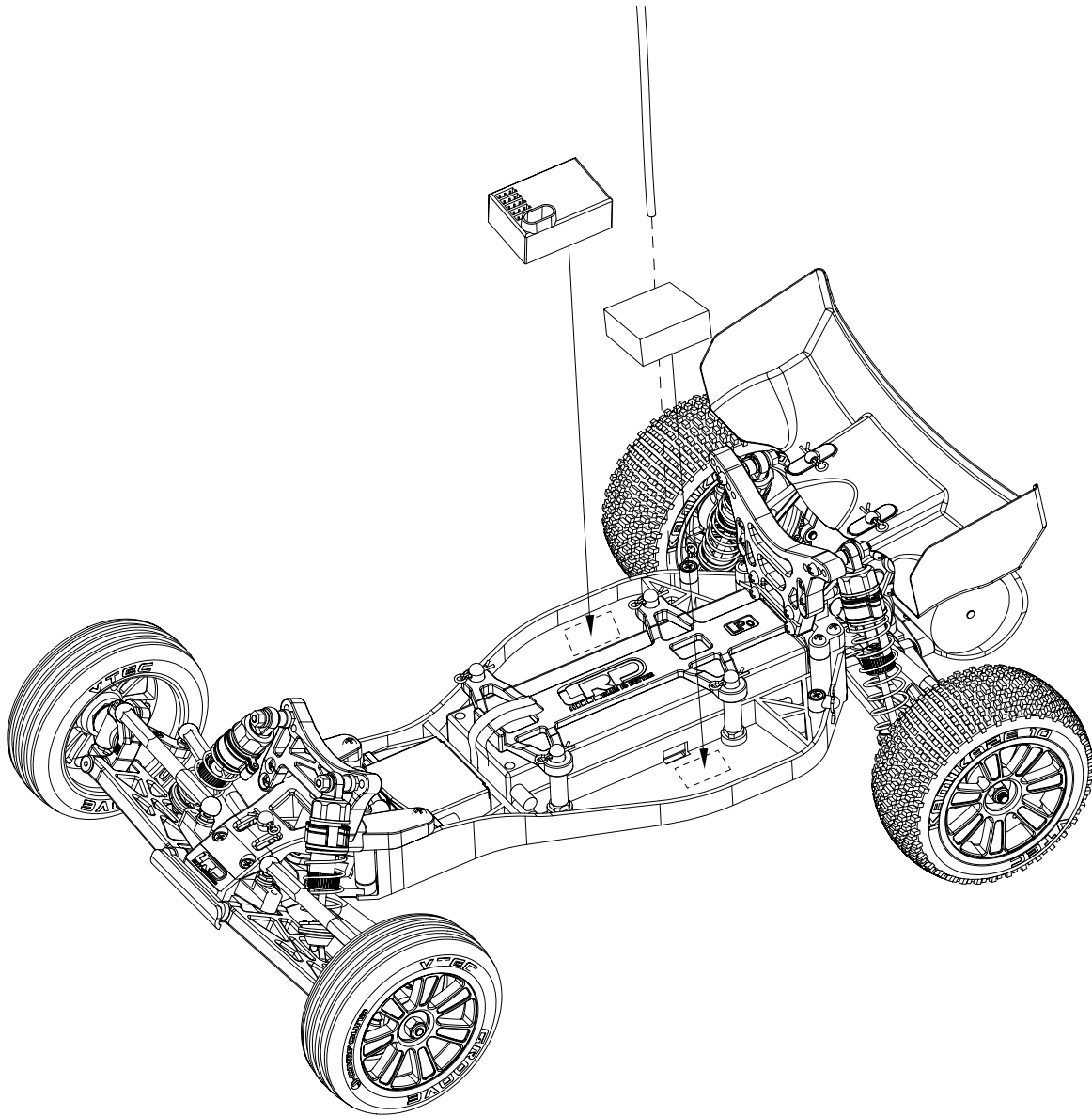

BAUABSCHNITTE CONSTRUCTION SECTIONS

34 BODY KAROSSERIE

